



Building with conscience.

StoPowerwall® ExtraSeal®

Design Guide and Detail Booklet
Series 65c.xx | January 2024

Facades



Exterior Wall Systems

StoPowerwall® ExtraSeal® is a stucco wall assembly with a continuous water resistive air barrier system for direct applications to concrete or concrete masonry (CMU) wall construction. It combines the strength and durability of traditional stucco with StoGuard® air and water protection and Sto high performance finishes.

StoPowerwall ExtraSeal® can be used in residential or commercial wall construction for superior aesthetics, durability, and air and moisture control.

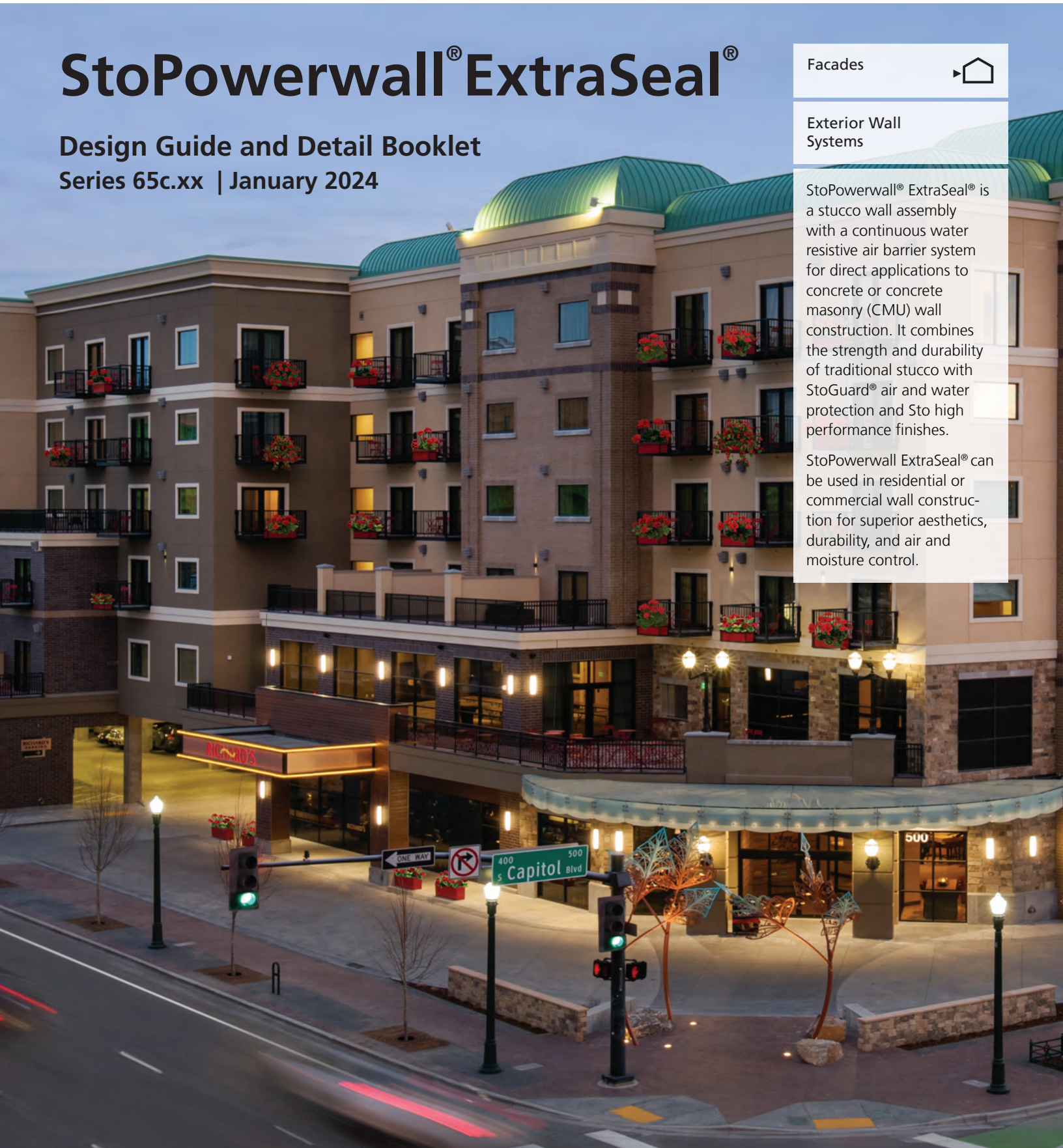



Design Guide



Table of Contents

System Overview	3
System Components	3
Assembly Diagram	6
General Notes	6
StoGuard Product Use Chart	11
Guide Details	12



ATTENTION

The final design of any project is the sole responsibility of the Design Professional, with considerations for compliance with local building and design codes and requirements. Sto Corp. accepts no liability for design, engineering, or workmanship of any project. The information provided herein is in addition to other technical data provided by Sto Corp. (System Bulletin, Specification, Guide Details, etc). For more information, please visit www.stocorp.com

Sto Corp.

3800 Camp Creek Pkwy. SW
Bldg. 1400 • Suite 120
Atlanta, GA 30331
Tel: (800) 221-2397
Fax: (404) 346-3119
<http://www.stocorp.com>
helpdesk.stocorp.com



StoPowerwall® ExtraSeal®

StoPowerwall ExtraSeal is a portland cement stucco wall covering that is intended for use over code compliant concrete and concrete masonry wall construction. It incorporates Sto ExtraSeal®, a trowel applied water-resistive air barrier, StoPowerwall® portland cement stucco, Sto primers, and Sto textured or StoCast finishes.

Sto ExtraSeal is the water-resistive air barrier component of the system and is applied as a skim coat and scratch coat directly to concrete and concrete masonry. StoPowerwall stucco is applied as a brown coat over the Sto ExtraSeal scratch coat. StoPowerwall stucco is ASTM C926¹ compliant and is installed in conformance with ASTM C926 practices. StoPowerwall stucco is available as a concentrate to which graded sand is added at the job site, or pre-sanded to simplify mixing in the field.

Sto proprietary integrally colored textured finishes or StoCast finishes are used in lieu of portland cement stucco finish to achieve brighter, richer colors and textures, and offer a wide variety of finish looks such as stone, brick, or wood on a single substrate. Aside from Sto proprietary blends of stucco, Sto Corp. also maintains a list of stucco vendors, whose products are suitable for use and warranted in StoPowerwall stucco wall assemblies. Refer to the **Addendum to StoPowerwall Specifications** for a listing of vendors, stucco types, information on building code compliance, and any limitations that may apply.

NOTE: Sto documents referenced in this booklet are in **bold** and can be viewed or downloaded by visiting the documentation center at www.stocorp.com, where other information - Guide Specification, System Bulletin, and Product Bulletins – is also available.

Trowel Applied Water-Resistive Air Barrier Product



Sto ExtraSeal® - Trowel applied, single component polymer modified portland cement-based water-resistive air barrier for use over prepared concrete and concrete masonry (CMU) walls.

Detail Component Products



Sto RapidGuard® - One-component air barrier and waterproof material used to protect rough openings, sheathing joints, seams, cracks, penetrations, and other transitions in above grade wall construction.



StoGuard® Conformable Membrane - A versatile, easy to install membrane that simplifies detailing of transitions for air barrier continuity in Sto proprietary wall systems and other wall assemblies.



Sto Gold Coat® - Roller or spray applied vapor-permeable air & water-resistive barrier designed for use in StoPowerwall® ExtraSeal® Systems.



Sto Gold Coat® TA - Trowel applied vapor-permeable air & water resistive barrier for use behind siding, brick, stone, adhered veneer, and StoPowerwall® systems.



Sto Gold Fill® - Trowel applied joint treatment and air barrier material used to treat rough openings, corners, and sheathing joints with StoGuard® Mesh or Sto Detail Mesh.



Detail Component Products (cont'd)



StoGuard® Fabric - Non-woven cloth reinforcement to treat joints, inside and outside corners and rough openings when embedded in Sto Gold Coat, Sto AirSeal, StoGuard VaporSeal or StoGuard VaporSeal R.



StoGuard® Mesh - Glass fiber, self-adhesive mesh for use with Sto Gold Fill and Sto Gold Coat TA as part of the StoGuard assembly.



Sto Mesh & Sto Detail Mesh - A variety of designed coated glass fiber meshes used to provide reinforcement and impact resistance in Sto claddings.



Sto Armor Mat & Sto Armor Mat XX - A heavy, specifically designed coated glass fiber mesh used to provide ultra-high impact resistance in Sto claddings.



StoGuard® RediCorner - A preformed StoGuard® fabric piece used in the corners of rough openings for quicker installation.

Patching and Leveling



Sto Leveler and Skim Coat - Trowel applied polymer modified cement-based patch and leveling material for applications up to 1/4 inch (6 mm) in depth

Stucco



StoPowerwall® Stucco - is a controlled blend of Portland cement, that performs like traditional stucco when combined with sand and water at the jobsite.



StoPowerwall® Pre-Blended - is a pre-blend of Portland cement with graded sand that performs like traditional stucco when combined with sand and water at the jobsite.



StoPowerwall® Scratch & Brown - is an ASTM C926 compliant, factory prepared portland cement stucco base coat to which sand and water are added at the job site. It is an integral component of a conventional one hour fire-rated stucco assembly.

Adhesives, Basecoats and Crack Defense System



Sto Stucco Mesh - is a tri-directional weave, flexible treated glass fiber mesh for use with portland cement stucco brown coats in vertical above grade wall construction.



Sto BTS® Plus - A trowel or spray applied, one-component, polymer-modified, high build cement based, dry powder material used as an adhesive and base coat.



Adhesives, Basecoats and Crack Defense System (continued)



Sto BTS® Xtra - A trowel or spray applied, lightweight factory blended one component polymer modified portland cement based extra high build base coat.



Sto Primer/Adhesive - A trowel or spray applied, two-component, polymer-modified, cement based, dry powder material used as a base coat.



Sto Primer/Adhesive-B - A trowel or spray applied, one-component, polymer-modified, cement based, dry powder material used as a base coat.



Sto RFP - A trowel or spray applied, ready mixed acrylic based fiber reinforced base coat material used as an adhesive and base coat.



Sto Flexyl - A trowel or spray applied, ready mixed acrylic based fiber reinforced waterproof base coat material used as an adhesive and base coat.



Sto TurboStick® - is a ready-to-use, single component polyurethane foam adhesive used for filling seams and gaps in penetrations and attachments, and as an adhesive to attach foam shapes or trim.

Primer (optional)



StoPrime® Hot - A roller, brush or sprayed applied primer that is alkali resistant and is used over prepared vertical above grade wall surfaces. This primer enables application of finish before the 28-day cure period for stucco.



StoPrime® - A roller, brush or sprayed applied, tintable, primer used to reduce surface water absorption of the base coat, and to enhance finish color, texture, and coverage of finishes.



StoPrime® Sand - A roller, brush or sprayed applied, tintable and sanded primer used to reduce surface water absorption of the base coat, and to enhance finish color, texture, and coverage of finishes.

Finishes



Please visit www.stocorp.com for information on a wide range of available Sto exterior decorative and protective Textured Finishes, Signature Finishes, Specialty Finishes, and StoCast Finishes as selected and approved by the design professional or owner on the basis of job site installed mock-ups.

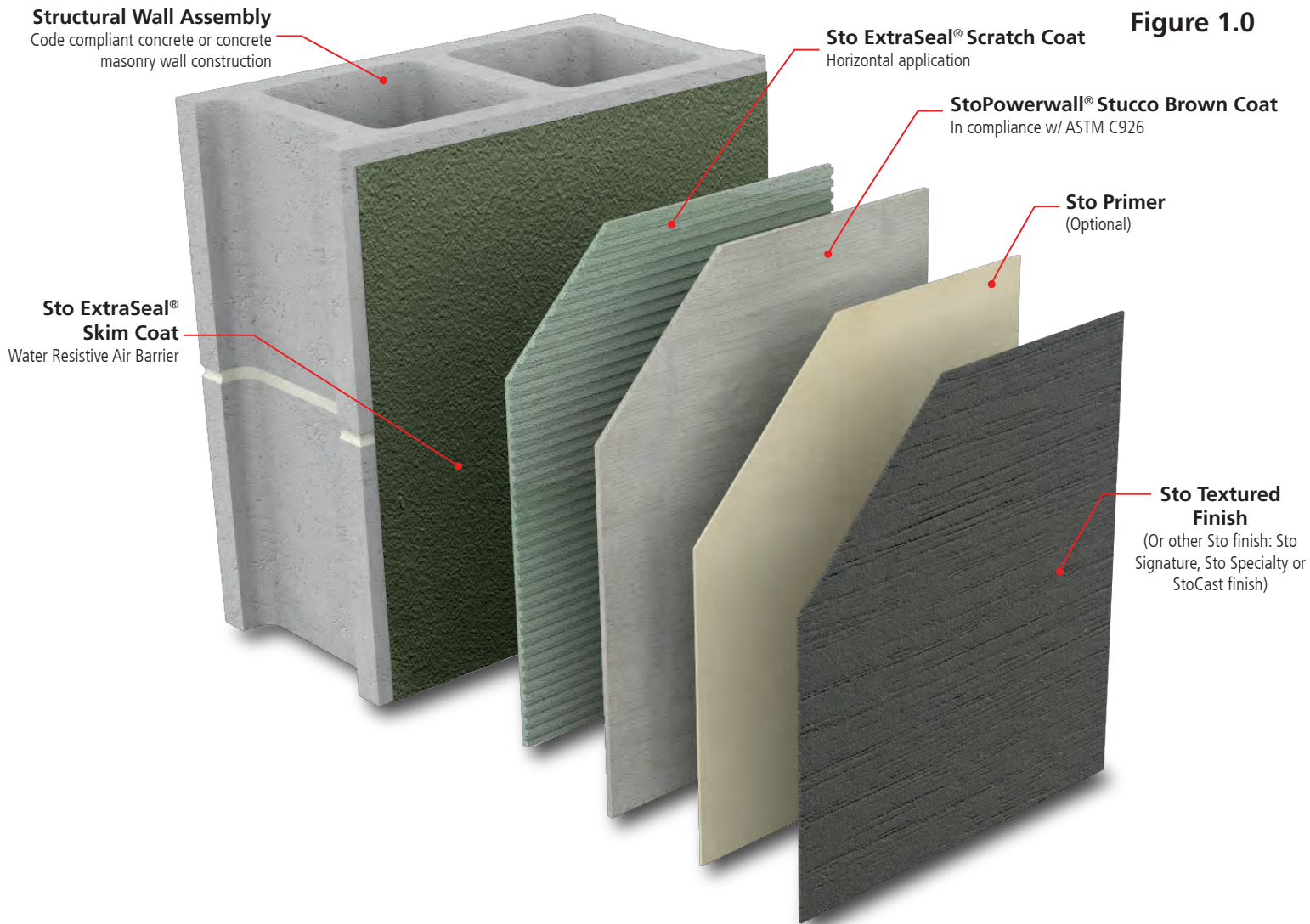

Structural Loads

1. Racking Loads, Load Bearing Walls:

Racking resistance in StoPowerwall ExtraSeal assemblies is provided by the structural backup of concrete or concrete masonry wall construction. Assuming the structural backup wall is load bearing, it also carries roof and floor loads. In all cases, stresses from racking and gravity loads are not to be transferred to the portland cement stucco wall covering, as they can cause cracking in the stucco.

2. Wind Loads:

StoPowerwall ExtraSeal transfers positive wind loads to the supporting wall construction and resists negative wind loads via adhesive attachment to the structural wall, which provides ultimate wind load resistance. Most important for adhesive attachment is substrate preparation to ensure that the surface is free from dust, dirt, grease, form oil, curing compounds, paints or coatings, efflorescence, salts, laitance or other surface conditions that could interfere with adhesion. The surface should be absorbent and slightly scarified or have surface roughness. StoPowerwall ExtraSeal components must not be installed over unprepared substrates or any substrate where adhesion is in question. Where the surface is too smooth, dense, or non-absorbent to receive the stucco components, or where form oil, an existing coating, or other surface contamination prohibits adhesion, furred or self-furred lath should be installed as specified by the design professional. Refer to StoPowerwall or StoPowerwall DrainScreen guide specifications and verify adequacy of lath attachment with respect to design wind pressures.



Structural Loads (cont'd)

3. Fixture Attachments: StoPowerwall ExtraSeal should not be used as a base for mechanical anchoring of attachments such as signage or light fixtures. Where fixtures must be attached, anchor into the structural backup wall.

Fire Protection

1. Noncombustible Construction:

StoPowerwall ExtraSeal can be used on Types I, II, III, and IV noncombustible wall construction. It is also suitable for use on Type V, combustible wall construction.

2. Fire Resistance-Rated Wall Assemblies:

In general, the StoPowerwall ExtraSeal system will not diminish the hourly rating of the concrete or concrete masonry backup wall construction. The 2021 IBC Table 721.1 (2) lists concrete and concrete masonry fire-resistance-rated wall assemblies to which StoPowerwall ExtraSeal can be added without changing the hourly rating. Also see **Fire Resistance Ratings of Concrete Masonry Assemblies (TEK 07-01D)**² published by the National Concrete Masonry Association.

Engineering judgements, modeling, or rational analysis by qualified fire protection engineers can also be used to determine if a particular wall assembly that includes StoPowerwall ExtraSeal will achieve an hourly rating.

Moisture Protection

1. Water-Resistive Air Barrier:

StoExtraSeal is a vapor permeable water-resistive air barrier and is installed directly to prepared vertical above grade concrete and concrete masonry substrates. Sto ExtraSeal is applied in two coats, first as a skim coat, which provides a smooth surface for connecting to other air barrier materials such as roofing membrane or foundation waterproofing, with appropriate air barrier transition components. Once the skim coat is applied and connecting air barrier transition components are in place, stucco accessories, such as casing beads, expansion and control joints are installed. Sto ExtraSeal is then applied as a scratch coat to which the StoPowerwall Stucco brown coat is applied. Sto ExtraSeal, when applied as directed, provides resistance to air leakage, and protection against water infiltration in the event of a breach in StoPowerwall Extraseal system while in service. It is not intended to correct faulty workmanship such as the absence or improper integration of flashing and coping in the wall assembly, nor is it intended to correct defective components of construction such as windows that leak into the wall assembly. Flashing should always be integrated in the wall assembly to direct water to the exterior, not into the wall assembly, particularly at potential leak sources such as windows.

As a component of an air barrier assembly Sto ExtraSeal minimizes the risk of condensation within the building envelope by resisting mass transfer of moisture in the air to a cold surface in the wall assembly. A complete air barrier system consists of individual air barrier materials installed on walls, roof, and foundation, and air barrier components, such as windows and doors. that must be connected continuously to create an effective air barrier system. Many of the transition details between the stucco wall assembly and the roof, wall, or adjacent components in the wall assembly are effectively made with StoGuard Detail Components to create a StoGuard water-resistive air barrier system. The design/construction professional must take construction sequencing into account when designing an "airtight" assembly to ensure continuity and long-term durability. The effects of air tightness on mechanical ventilation should also be included in the overall project design.



Moisture Protection (cont'd)

Water-Resistive Air Barrier: (cont'd)

An air barrier should not be confused with a vapor retarder, which may also be used in the wall assembly to retard water vapor diffusion and reduce the risk of condensation. Generally, a vapor retarder is placed on the warm side of the insulation. Specifically, it is placed on the interior side of the insulation in cold climates. A vapor retarder may not be necessary, or appropriate, depending on the wall components and the range of temperature/humidity conditions inside and outside. A vapor retarder should not be used on the inside of walls in hot, humid climates. A dew point analysis and/or dynamic hygrothermal modeling should be performed to determine whether a vapor retarder is appropriate. Sto manufactures vapor permeable, vapor retarder, and vapor impermeable air barriers/water-resistive barriers for use in StoPowerwall assemblies.

Refer to information at www.stocorp.com.

2. Flashing:

Flashing is required to direct water to the exterior where it is likely to penetrate components in the wall assembly and to divert water away from, not into, the exterior wall, including, above window and door heads, beneath window and door sills, at roof/wall intersections, decks, abutments of lower walls with higher walls, above projecting features, at floor lines, and at the base of the wall.

3. Grade Condition:

Stucco is required to terminate minimum 4-inches (102mm) above earth grade, and minimum 2-inches above hardscape (pavers/sidewalk). Increased clearance should be provided in freeze/thaw climate zones where snow drifts can accumulate against the wall surface. Do not use StoPowerwall ExtraSeal below grade.

4. Other Moisture Protection Considerations:

Do not use StoPowerwall ExtraSeal on surfaces subject to continuous or intermittent water immersion or hydrostatic pressure. Prevent the accumulation of water behind StoPowerwall ExtraSeal, either by condensation or water leakage into the wall construction, in the design and detailing of the wall assembly, and with proper sequencing and protective measures during construction.

Do not use the StoPowerwall ExtraSeal on roofs or roof-like conditions. Do not use StoPowerwall ExtraSeal on parapets, weather exposed projecting ledges, sills, or other projecting features, unless supported by framing or other structural support and protected with metal coping or flashing. Refer to Sto Details.

For further information see Sto Tech Hotline No. 0403-BSc, **Critical Detail Checklist for Wall Assemblies**, Sto Tech Hotline No. 0603-BSc, **Moisture Control Principles for Design and Construction of Wall Assemblies**, and Sto Tech Hotline No. 1001-BSc, **Effects of Temporary Heating on Construction Materials in Cold Weather**

Thermal Insulation

StoPowerwall assemblies are insulated in the stud cavity of frame walls built on the interior of concrete or concrete masonry wall construction, or with insulation applied directly to the interior of the wall. For more effective and efficient thermal insulation and where continuous insulation is required by building codes, refer to StoPowerwall ci, an exterior insulated stucco wall assembly with continuous XPS (Extruded Polystyrene) insulation.



Impact Resistance

StoPowerwall ExtraSeal is an impact resistant wall system, often specified for use on ground floors and other areas where abuse and impact resistance are important. Other Sto systems, such as StoPowerwall HI, comply with Miami-Dade County requirements for large and small missile impact resistance, for areas of the country under the threat of hurricanes.

Refer to information at www.stocorp.com.

Color Selection

Certain highly saturated colors such as dark blue, violet, or fire engine red require the use of organic tints to achieve their color. Organic tints are more prone to fade than inorganic tints. See Sto Tech Hotline No. 0893-EC, **Fading in EIFS and Architectural Coatings**, for further information on this topic and how to avoid color problems. Surface alkalinity (pH) can also affect final color of finishes and is an important consideration for stucco surfaces that will receive acrylic or acrylic elastomeric finishes, such as those specified for use in StoPowerwall assemblies. A surface pH of less than 10 is recommended. pH should be checked at multiple locations on the wall before primer or finish is applied. A minimum cure time of 28 days is generally recommended before applying finishes to allow the pH of the stucco surface to neutralize. StoPrime Hot is the preferred primer for use on stucco surfaces as it “masks” surface alkalinity and reduces the time period between application of stucco and finish, allowing for finish application in less than 28 days. Refer to Sto Tech Hotline No. 1202-CF, **Alkaline Substrates and Polymeric Finishes**.

Joints

1. At through wall expansion joints and at joints formed with back-to-back casing beads, back joints with the appropriate StoGuard Detail Component. Care must be taken when backing casing beads or other accessories with membrane tapes or other impervious materials to terminate them at the edges of expanded flange accessories, as neither Sto ExtraSeal nor StoPowerwall Stucco will adhere to them. Refer to Sto Details. Seal stucco terminations and accessory butt joints with appropriate sealant and seal all penetrations through the stucco wall assembly with appropriate backer rod and sealant, as dictated by joint type.
2. Expansion and control joints are required in stucco wall assemblies to prevent or minimize the risk of cracking. Below is a list of general rules for the use of joints and accessories. Also, refer to Sto Details.
 - Provide two-piece expansion joints in the stucco assembly where building movement is anticipated: at joints in the substrate or supporting construction, where the system is to be installed over dissimilar construction or substrates, at changes in building height, at floor lines, and at columns and cantilevered areas.
 - Provide one piece expansion joints every 144 ft² (13 m²). Do not exceed length to width ratio of 2-1/2:1 in expansion joint layout and do not exceed more than 18 feet (5.5 m) in any direction without an expansion joint. Where casing bead is used back-to-back at the expansion joint, back the joint with the appropriate StoGuard Detail Component. In some cases the spacing of joints may be increased to a maximum of 240 ft² (22.3m²) to accommodate joint spacing within the backup concrete or concrete masonry wall construction. If spacing is increased exercise care with other aspects of the stucco installation to minimize the risk of cracking.
 - Provide one piece expansion joints at through wall penetrations, for example, at corners above and below doors and windows.
 - Provide minimum 3/8 inch (9 mm) wide sealant joints where the stucco abuts windows, doors and other through wall penetrations, and terminate the stucco with casing bead.
 - Provide appropriate accessories at stucco terminations and joints.
 - Avoid the use of channel reveal accessories which can interfere with proper stress relief (channel reveal accessories do not function as control or expansion joints, unless specifically designed to accommodate movement).



Joins (cont'd)

- Provide appropriate sealant at stucco terminations and at stucco accessory butt joints.
- Indicate location of joints, accessories, and accessory type on architectural drawings.
- Maintain water-resistive air barrier continuity at joints with StoGuard Detail Components.

Trim, Reveals, and Projecting Architectural Features

In general, trim around windows, at floor lines, and other areas of construction is simpler and faster to achieve with EPS foam trim than forming it with stucco. All foam trim and projecting architectural features should have a minimum 1:2 [27°] slope along their top surface. Minimum ¾-inch (19 mm) foam thickness must remain beneath all finished reveals. All horizontal reveals should have a minimum 1:2 [27°] slope along their bottom surface. Slope should be increased for northern climates to prevent accumulation of ice/snow and water on the sloped surface. Where foam trim or the bottom surface of reveals project more than 2-inches (51 mm) from the face of the StoPowerwall ExtraSeal wall plane, the top surface should be protected with waterproof base coat. Periodic inspections and increased maintenance may be required to maintain appearance and surface integrity of finishes installed on weather exposed sloped surfaces. Limit projecting features to easily accessible areas and limit total area to facilitate and minimize maintenance. Refer to Sto Details.

Efflorescence

Efflorescence is a normal occurrence in portland cement-based products and can affect final appearance of finish products installed over stucco. Efflorescence is generally caused by water getting into or behind the stucco and migrating to the exterior while carrying soluble salts that are within concrete, masonry, stucco and other portland cement-based materials. Proper proportioning of stucco ingredients, proper placement of stucco, and moist curing of the stucco to fully hydrate the portland cement in the stucco mix will provide a stucco that is resistant to water penetration and will minimize efflorescence. The use of a primer such as StoPrime Hot, specifically designed to resist efflorescence, and Sto high performance finishes, will add to the water penetration resistance of the stucco wall assembly. Protective measures during construction to prevent water from getting into the wall, along with the use of flashing, coping, overhangs, and other methods of construction that keep water away from the wall will also help to prevent or minimize efflorescence.

Cracking

Some degree of cracking is normal in portland cement stucco and should be expected. Cracking is generally not caused by a material defect in the stucco and can be minimized by following sound design and construction practice such as: proper installation of accessories, proper incorporation of stress relief joints in the construction, the use of properly graded sand, proper proportioning of stucco mix ingredients, use of the minimum amount of water in the stucco mix for placement and avoiding the use of excess water, moist curing of the stucco after it has been applied, and proper sequencing of construction to avoid stresses in the freshly placed stucco. For example, roof loads should be in place before stucco is applied to exterior load bearing walls, and interior drywall should be installed on the inside of exterior walls before the stucco is installed to avoid stress transfer to freshly placed stucco.

Additional protection against cracking can be achieved by adding Sto Crack Defense, a Sto glass fiber mesh reinforced layer embedded in Sto base coat, to the outer surface of the cured stucco brown coat, before the exterior finish is installed. Refer to Sto Details.

References

¹ Standard Specification for Application of Portland Cement-Based Plaster, ASTM C926-20, ASTM International, West Conshohocken, PA.

² Fire Resistance Ratings of Concrete Masonry Assemblies, TEK 07-01D, National Concrete Masonry Association, Herndon, VA.



Table 1.1 - StoGuard® Air & Water-Resistive Barrier Product Applications

StoGuard® Detail Component	Sheathing Joints and Corners	Flashing and Rough Opening Protection	Penetrations	Static Joints and Seams	Dynamic Joints
Sto RapidGuard®	✓	✓	✓	✓	
StoGuard® Conformable Membrane	✓	✓	✓	✓	✓



Guide Details

Components

System Components	65c.00
System Components with StoCast Brick	66c.00 SCB
System Components with StoCast Wood	65c.00 SCW
System Components with MVES (Masonry Veneer Engineered System)	65c.00 MVES
System Components with Sto Crack Defense System	65c.00A CDS

Installation at Grade

Termination at Grade	65c.01
Termination at Balcony	65c.10

Installation at Joints

Floor Line Joint	65c.21
------------------------	--------

Installation at Windows

Rough Opening Protection	65c.23
Box Window - Sill/Jamb	65c.27
Box Window - Head	65c.28

Installation at Soffit

Soffit: Uninsulated and Vented	65c.30
--------------------------------------	--------

Installation at Dissimilar Material

Unrestrained Joint at Dissimilar Material at Column Interface	65c.41A
Restrained Joint at Dissimilar Material at Column Interface	65c.41B

Installation at Parapet, Saddle Flashing and Buildouts

Aesthetic Feature	65c.60
Pipe Penetration	65c.70
Parapet	65c.81



ATTENTION

The final design of any project is the sole responsibility of the Design Professional, with considerations for compliance with local building and design codes and requirements. Sto Corp. accepts no liability for design, engineering, or workmanship of any project. The information provided herein is in addition to other technical data provided by Sto Corp. (System Bulletin, Specification, Guide Details, etc). For more information, please visit www.stocorp.com

Sto Corp.

3800 Camp Creek Pkwy. SW
Bldg. 1400 • Suite 120
Atlanta, GA 30331
Tel: (800) 221-2397
Fax: (404) 346-3119
<http://www.stocorp.com>
helpdesk.stocorp.com

StoPowerwall® ExtraSeal® System Components

Detail No.: 65c.00
Date: January 2024

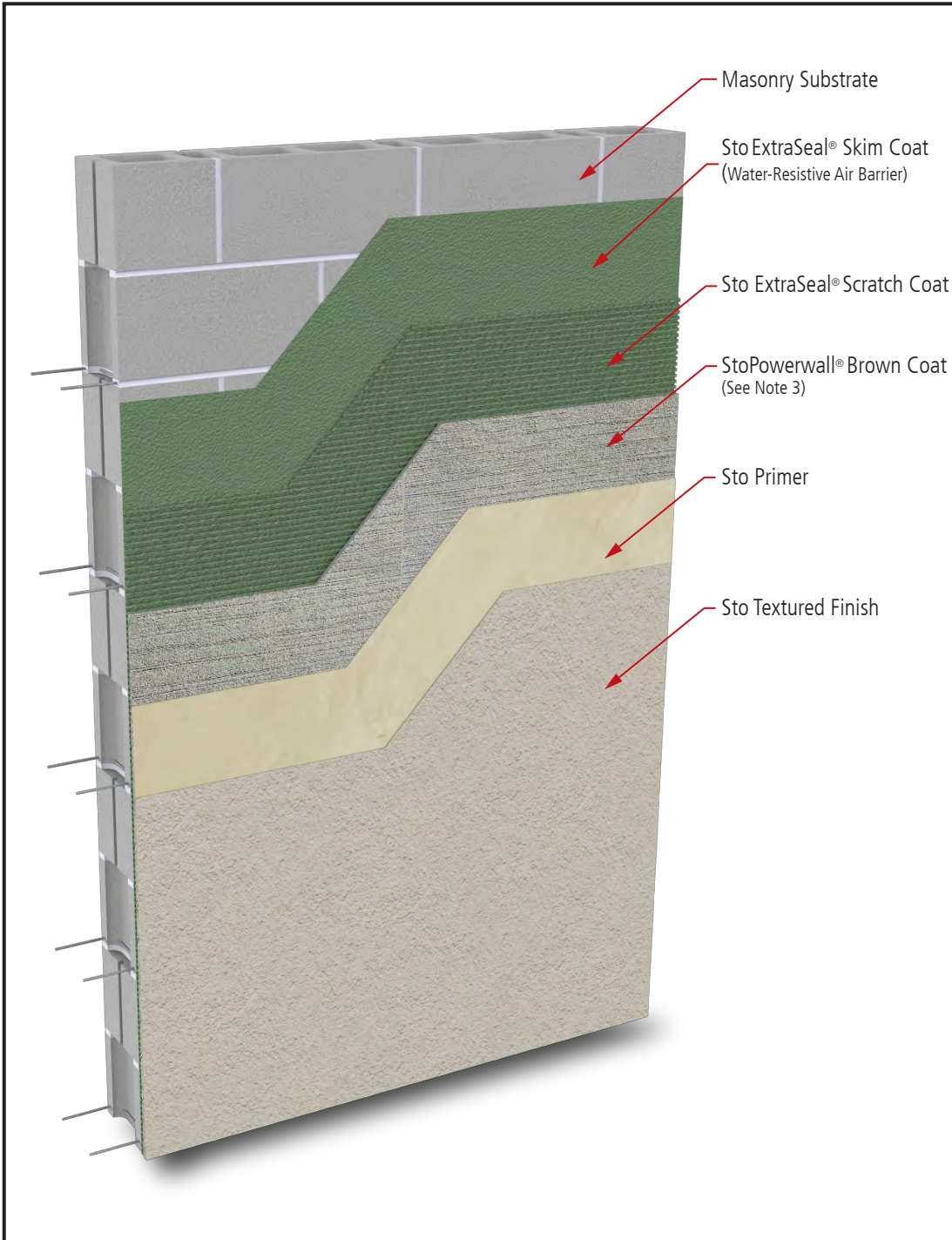

- Notes:**
1. Refer to StoGuard Product Use Chart (Table 1.1) for StoGuard detail components; joint treatment, rough opening protection, backing for masonry anchors, or transitions to dissimilar materials, joints and seams in construction.
 2. Refer to General Notes for specific information and design guidance on wall assembly components.
 3. Stucco brown coat material in compliance with ASTM C926 and manufactured or listed by Sto Corp.
 4. Refer to applicable Sto guide specifications, product bulletins, Tech Hotlines, and other Sto guide details for additional information.
 5. Components not identified as Sto are furnished by other manufacturers and are not necessarily installed by trades who install the Sto products. Refer to project specific contract documents.

ATTENTION

Property of Sto Corp. All Rights Reserved.

Sto products are intended for use by qualified professional contractors, not consumers, as a component of a larger construction assembly as specified by a qualified design professional, general contractor or builder. They should be installed in accordance with those specifications and Sto's instructions. Sto Corp. disclaims all, and assumes no, liability for on-site inspections, for its products applied improperly, or by unqualified persons or entities, or as part of an improperly designed or constructed building, for the nonperformance of adjacent building components or assemblies, of for other construction activities beyond Sto's control. Improper use of Sto products or use as part of an improperly designed or constructed larger assembly or building may result in serious damage to Sto products, and to the structure of the building or its components.

STO CORP. DISCLAIMS ALL WARRANTIES EXPRESSED OR IMPLIED EXCEPT FOR EXPLICIT LIMITED WRITTEN WARRANTIES ISSUED TO AND ACCEPTED BY BUILDING OWNERS IN ACCORDANCE WITH STO'S WARRANTY PROGRAMS WHICH ARE SUBJECT TO CHANGE FROM TIME TO TIME. For the fullest, most current information on proper application, clean-up, mixing and other specifications and warranties, cautions and disclaimers, please refer to the Sto Corp. website, www.stocorp.com.

www.stocorp.com



StoPowerwall® ExtraSeal® with StoCast Brick

Detail No.: 65c.00 SCB
Date: January 2024

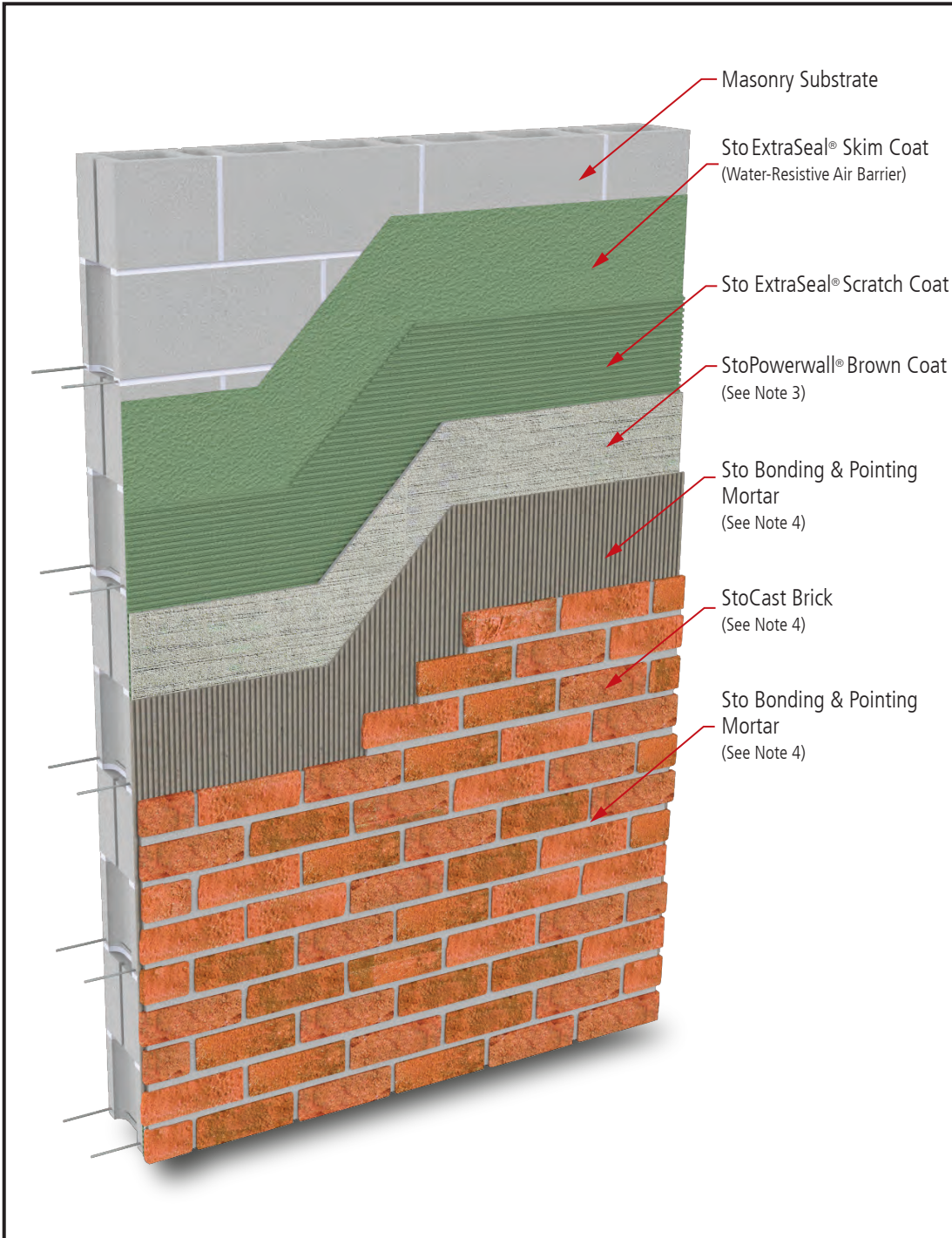

- Notes:**
1. Refer to StoGuard Product Use Chart (Table 1.1) for StoGuard detail components; joint treatment, rough opening protection, backing for masonry anchors, or transitions to dissimilar materials, joints and seams in construction.
 2. Refer to General Notes for specific information and design guidance on wall assembly components.
 3. Stucco brown coat material in compliance with ASTM C926 and manufactured or listed by Sto Corp.
 4. Refer to the StoCast Brick Application Guide for more information.
 5. Refer to applicable Sto guide specifications, product bulletins, Tech Hotlines, and other Sto guide details for additional information.
 6. Components not identified as Sto are furnished by other manufacturers and are not necessarily installed by trades who install the Sto products. Refer to project specific contract documents.

ATTENTION

Property of Sto Corp. All Rights Reserved.

Sto products are intended for use by qualified professional contractors, not consumers, as a component of a larger construction assembly as specified by a qualified design professional, general contractor or builder. They should be installed in accordance with those specifications and Sto's instructions. Sto Corp. disclaims all, and assumes no, liability for on-site inspections, for its products applied improperly, or by unqualified persons or entities, or as part of an improperly designed or constructed building, for the nonperformance of adjacent building components or assemblies, or for other construction activities beyond Sto's control. Improper use of Sto products or use as part of an improperly designed or constructed larger assembly or building may result in serious damage to Sto products, and to the structure of the building or its components.

STO CORP. DISCLAIMS ALL WARRANTIES EXPRESSED OR IMPLIED EXCEPT FOR EXPLICIT LIMITED WRITTEN WARRANTIES ISSUED TO AND ACCEPTED BY BUILDING OWNERS IN ACCORDANCE WITH STO'S WARRANTY PROGRAMS WHICH ARE SUBJECT TO CHANGE FROM TIME TO TIME. For the fullest, most current information on proper application, clean-up, mixing and other specifications and warranties, cautions and disclaimers, please refer to the Sto Corp. website, www.stocorp.com.

www.stocorp.com



StoPowerwall® ExtraSeal® with StoCast Wood

Detail No.: 65c.00 SCW
Date: January 2024

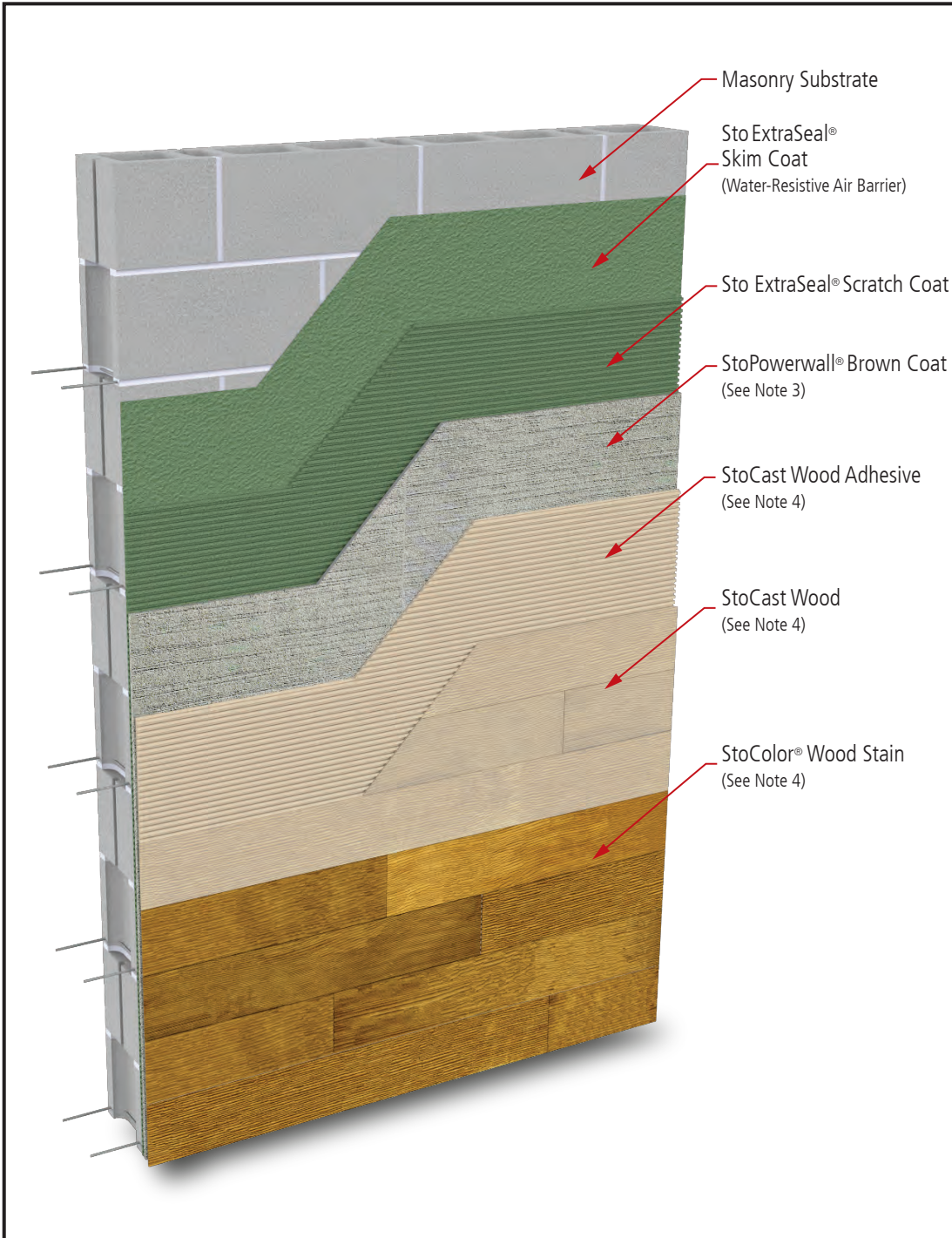

Notes:

1. Refer to StoGuard Product Use Chart (Table 1.1) for StoGuard detail components; joint treatment, rough opening protection, backing for masonry anchors, or transitions to dissimilar materials, joints and seams in construction.
2. Refer to General Notes for specific information and design guidance on wall assembly components.
3. Stucco brown coat material in compliance with ASTM C926 and manufactured or listed by Sto Corp.
4. Refer to the StoCast Wood Application Guide for more information.
5. Refer to applicable Sto guide specifications, product bulletins, Tech Hotlines, and other Sto guide details for additional information.
6. Components not identified as Sto are furnished by other manufacturers and are not necessarily installed by trades who install the Sto products. Refer to project specific contract documents.

ATTENTION

Property of Sto Corp. All Rights Reserved.

Sto products are intended for use by qualified professional contractors, not consumers, as a component of a larger construction assembly as specified by a qualified design professional, general contractor or builder. They should be installed in accordance with those specifications and Sto's instructions. Sto Corp. disclaims all, and assumes no, liability for on-site inspections, for its products applied improperly, or by unqualified persons or entities, or as part of an improperly designed or constructed building, for the nonperformance of adjacent building components or assemblies, or for other construction activities beyond Sto's control. Improper use of Sto products or use as part of an improperly designed or constructed larger assembly or building may result in serious damage to Sto products, and to the structure of the building or its components.

STO CORP. DISCLAIMS ALL WARRANTIES EXPRESSED OR IMPLIED EXCEPT FOR EXPLICIT LIMITED WRITTEN WARRANTIES ISSUED TO AND ACCEPTED BY BUILDING OWNERS IN ACCORDANCE WITH STO'S WARRANTY PROGRAMS WHICH ARE SUBJECT TO CHANGE FROM TIME TO TIME. For the fullest, most current information on proper application, clean-up, mixing and other specifications and warranties, cautions and disclaimers, please refer to the Sto Corp. website, www.stocorp.com.

www.stocorp.com



StoPowerwall® ExtraSeal® with Masonry Veneer Engineered System (MVES)

Detail No.: 65c.00 MVES
Date: January 2024

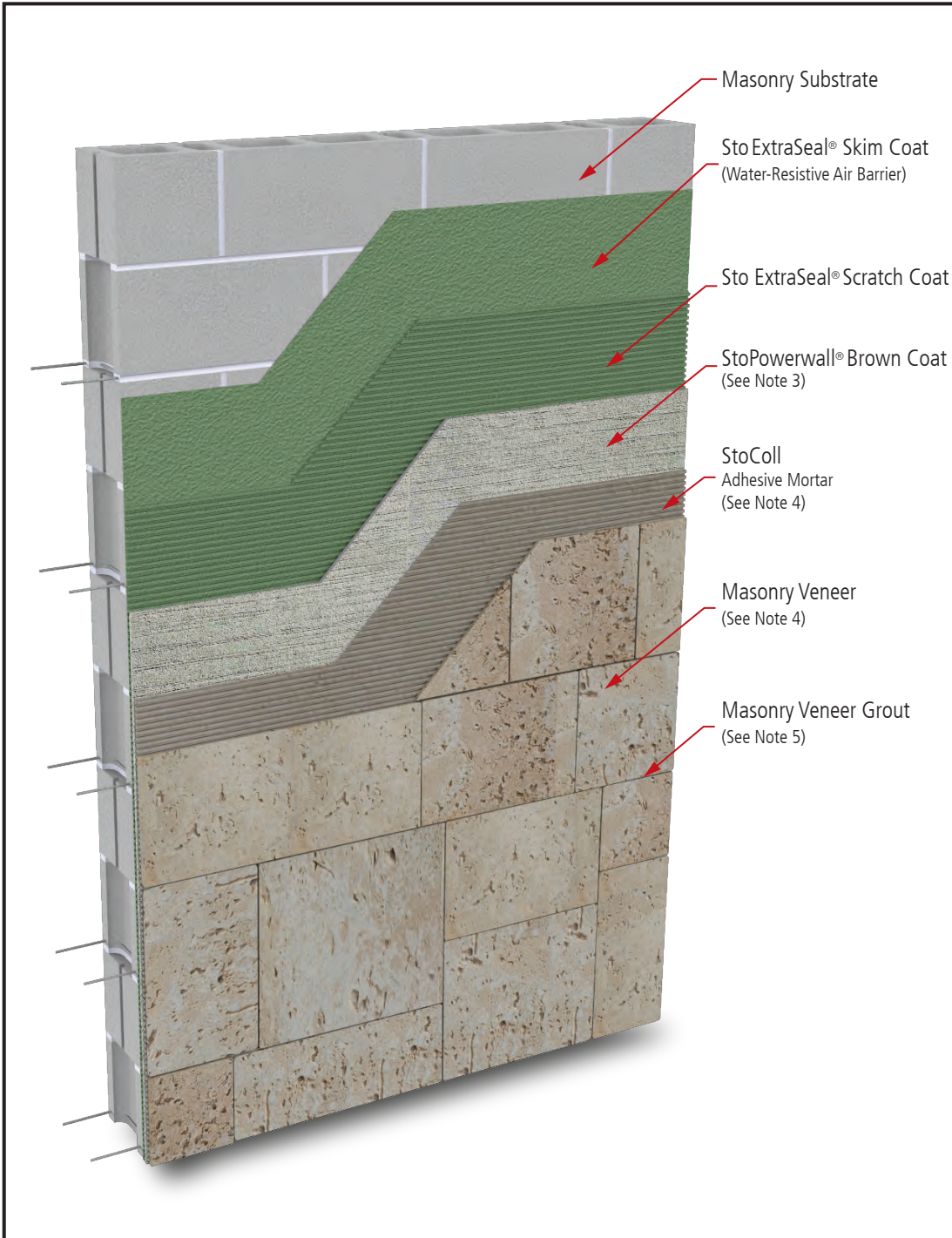

Notes:

1. Refer to StoGuard Product Use Chart (Table 1.1) for StoGuard detail components; joint treatment, rough opening protection, backing for masonry anchors, or transitions to dissimilar materials, joints and seams in construction.
2. Refer to General Notes for specific information and design guidance on wall assembly components.
3. Stucco brown coat material in compliance with ASTM C926 and manufactured or listed by Sto Corp.
4. Veneer options: thin brick, thin stone, ceramic tile or manufactured stone in conformance with applicable building code requirements.
5. Portland cement-based grout / pointing mortar in compliance with ANSI 118.7
6. Components not identified as Sto are furnished by other manufacturers and are not necessarily installed by trades who install the Sto products. Refer to project specific contract documents.

ATTENTION

Property of Sto Corp. All Rights Reserved.

Sto products are intended for use by qualified professional contractors, not consumers, as a component of a larger construction assembly as specified by a qualified design professional, general contractor or builder. They should be installed in accordance with those specifications and Sto's instructions. Sto Corp. disclaims all, and assumes no, liability for on-site inspections, for its products applied improperly, or by unqualified persons or entities, or as part of an improperly designed or constructed building, for the nonperformance of adjacent building components or assemblies, or for other construction activities beyond Sto's control. Improper use of Sto products or use as part of an improperly designed or constructed larger assembly or building may result in serious damage to Sto products, and to the structure of the building or its components.

STO CORP. DISCLAIMS ALL WARRANTIES EXPRESSED OR IMPLIED EXCEPT FOR EXPLICIT LIMITED WRITTEN WARRANTIES ISSUED TO AND ACCEPTED BY BUILDING OWNERS IN ACCORDANCE WITH STO'S WARRANTY PROGRAMS WHICH ARE SUBJECT TO CHANGE FROM TIME TO TIME. For the fullest, most current information on proper application, clean-up, mixing and other specifications and warranties, cautions and disclaimers, please refer to the Sto Corp. website, www.stocorp.com.

www.stocorp.com



StoPowerwall® ExtraSeal® Sto Crack Defense System

Detail No.: 65c.00A CDS
Date: January 2024

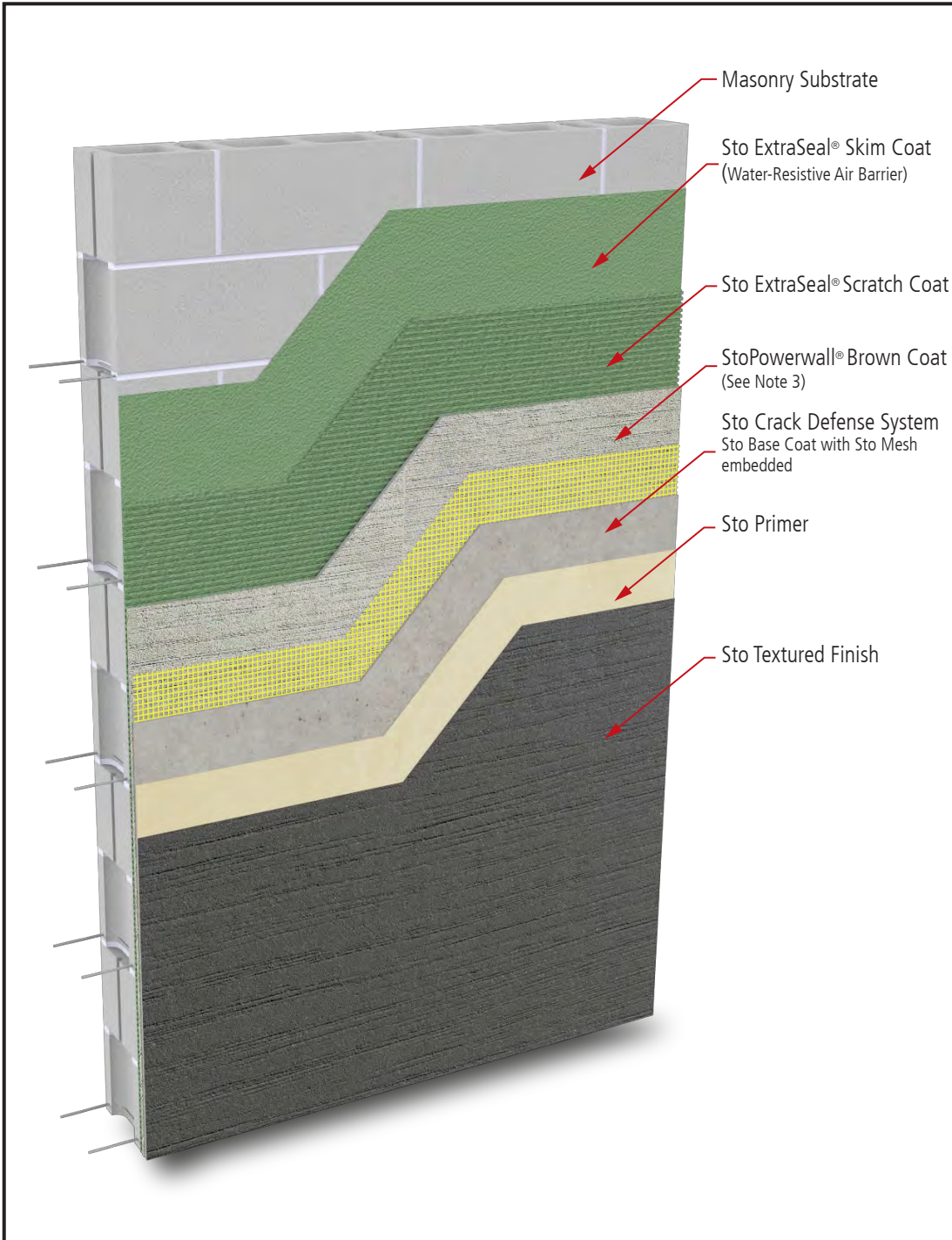

Notes:

1. Refer to StoGuard Product Use Chart (Table 1.1) for StoGuard detail components; joint treatment, rough opening protection, backing for masonry anchors, or transitions to dissimilar materials, joints and seams in construction.
2. Refer to General Notes for specific information and design guidance on wall assembly components.
3. Stucco brown coat material in compliance with ASTM C926 and manufactured or listed by Sto Corp.
4. Refer to applicable Sto guide specifications, product bulletins, Tech Hotlines, and other Sto guide details for additional information.
5. Components not identified as Sto are furnished by other manufacturers and are not necessarily installed by trades who install the Sto products. Refer to project specific contract documents.

ATTENTION

Property of Sto Corp. All Rights Reserved.

Sto products are intended for use by qualified professional contractors, not consumers, as a component of a larger construction assembly as specified by a qualified design professional, general contractor or builder. They should be installed in accordance with those specifications and Sto's instructions. Sto Corp. disclaims all, and assumes no, liability for on-site inspections, for its products applied improperly, or by unqualified persons or entities, or as part of an improperly designed or constructed building, for the nonperformance of adjacent building components or assemblies, or for other construction activities beyond Sto's control. Improper use of Sto products or use as part of an improperly designed or constructed larger assembly or building may result in serious damage to Sto products, and to the structure of the building or its components.

STO CORP. DISCLAIMS ALL WARRANTIES EXPRESSED OR IMPLIED EXCEPT FOR EXPLICIT LIMITED WRITTEN WARRANTIES ISSUED TO AND ACCEPTED BY BUILDING OWNERS IN ACCORDANCE WITH STO'S WARRANTY PROGRAMS WHICH ARE SUBJECT TO CHANGE FROM TIME TO TIME. For the fullest, most current information on proper application, clean-up, mixing and other specifications and warranties, cautions and disclaimers, please refer to the Sto Corp. website, www.stocorp.com.

www.stocorp.com



StoPowerwall® ExtraSeal® Termination at Grade

Detail No.: 65c.01
Date: January 2024

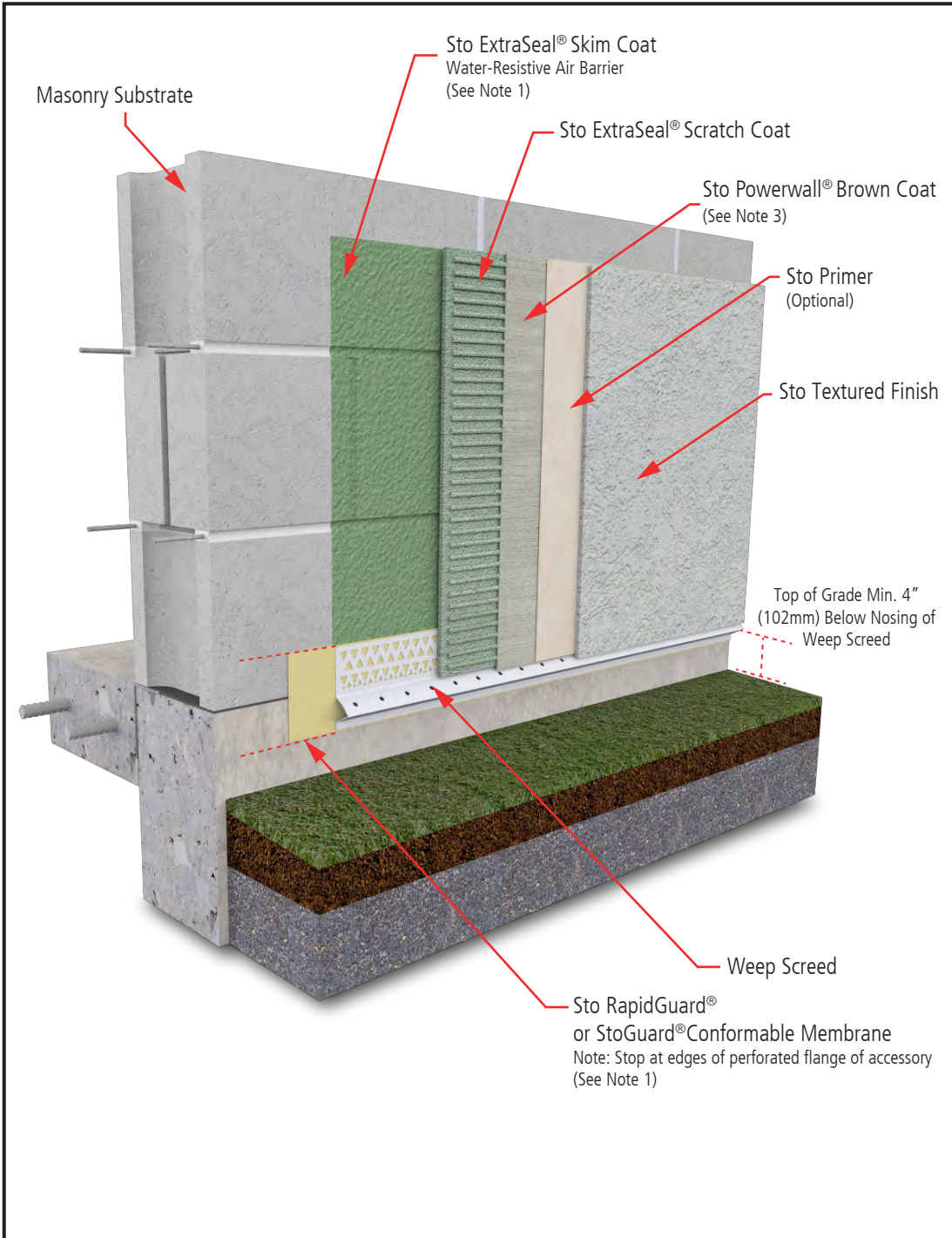

Notes:

1. Refer to StoGuard Product Use Chart (Table 1.1) for StoGuard detail components; joint treatment, rough opening protection, backing for masonry anchors, or transitions to dissimilar materials, joints and seams in construction.
2. Refer to General Notes for specific information and design guidance on wall assembly components.
3. Stucco brown coat material in compliance with ASTM C926 and manufactured or listed by Sto Corp.
4. Components not identified as Sto are furnished by other manufacturers and are not necessarily installed by trades who install the Sto products. Refer to project specific contract documents.

ATTENTION

Property of Sto Corp. All Rights Reserved.

www.stocorp.com

Sto products are intended for use by qualified professional contractors, not consumers, as a component of a larger construction assembly as specified by a qualified design professional, general contractor or builder. They should be installed in accordance with those specifications and Sto's instructions. Sto Corp. disclaims all, and assumes no, liability for on-site inspections, for its products applied improperly, or by unqualified persons or entities, or as part of an improperly designed or constructed building, for the nonperformance of adjacent building components or assemblies, of for other construction activities beyond Sto's control. Improper use of Sto products or use as part of an improperly designed or constructed larger assembly or building may result in serious damage to Sto products, and to the structure of the building or its components.

STO CORP. DISCLAIMS ALL WARRANTIES EXPRESSED OR IMPLIED EXCEPT FOR EXPLICIT LIMITED WRITTEN WARRANTIES ISSUED TO AND ACCEPTED BY BUILDING OWNERS IN ACCORDANCE WITH STO'S WARRANTY PROGRAMS WHICH ARE SUBJECT TO CHANGE FROM TIME TO TIME. For the fullest, most current information on proper application, clean-up, mixing and other specifications and warranties, cautions and disclaimers, please refer to the Sto Corp. website, www.stocorp.com.



StoPowerwall® ExtraSeal® Termination at Balcony

Detail No.: 65c.10
Date: January 2024

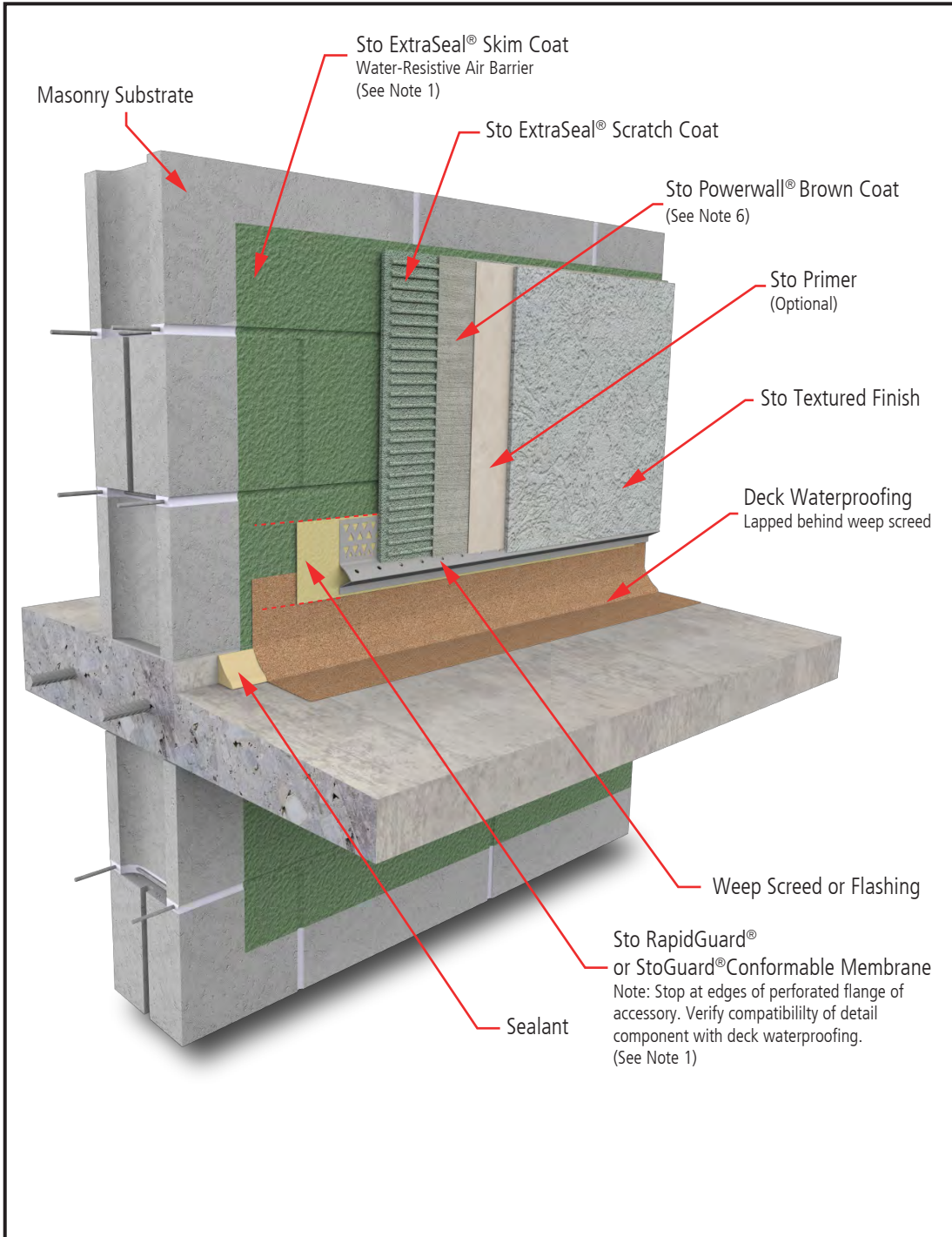

Notes:

1. Refer to StoGuard Product Use Chart (Table 1.1) for StoGuard detail components; joint treatment, rough opening protection, backing for masonry anchors, or transitions to dissimilar materials, joints and seams in construction.
2. Refer to General Notes for specific information and design guidance on wall assembly components.
3. Provide continuity of water protection at the wall/deck interface.
4. Provide clearance between the underside of the stucco and the deck to allow adequate drainage.
5. Lap StoGuard® Detail component onto weep screed to direct water to the exterior.
6. Stucco brown coat material in compliance with ASTM C926 and manufactured or listed by Sto Corp.
7. Components not identified as Sto are furnished by other manufacturers and are not necessarily installed by trades who install the Sto products. Refer to project specific contract documents.

ATTENTION

Property of Sto Corp. All Rights Reserved.

www.stocorp.com

Sto products are intended for use by qualified professional contractors, not consumers, as a component of a larger construction assembly as specified by a qualified design professional, general contractor or builder. They should be installed in accordance with those specifications and Sto's instructions. Sto Corp. disclaims all, and assumes no, liability for on-site inspections, for its products applied improperly, or by unqualified persons or entities, or as part of an improperly designed or constructed building, for the nonperformance of adjacent building components or assemblies, of for other construction activities beyond Sto's control. Improper use of Sto products or use as part of an improperly designed or constructed larger assembly or building may result in serious damage to Sto products, and to the structure of the building or its components.

STO CORP. DISCLAIMS ALL WARRANTIES EXPRESSED OR IMPLIED EXCEPT FOR EXPLICIT LIMITED WRITTEN WARRANTIES ISSUED TO AND ACCEPTED BY BUILDING OWNERS IN ACCORDANCE WITH STO'S WARRANTY PROGRAMS WHICH ARE SUBJECT TO CHANGE FROM TIME TO TIME. For the fullest, most current information on proper application, clean-up, mixing and other specifications and warranties, cautions and disclaimers, please refer to the Sto Corp. website, www.stocorp.com.



StoPowerwall® ExtraSeal® Floor Line

Detail No.: 65c.21
Date: January 2024

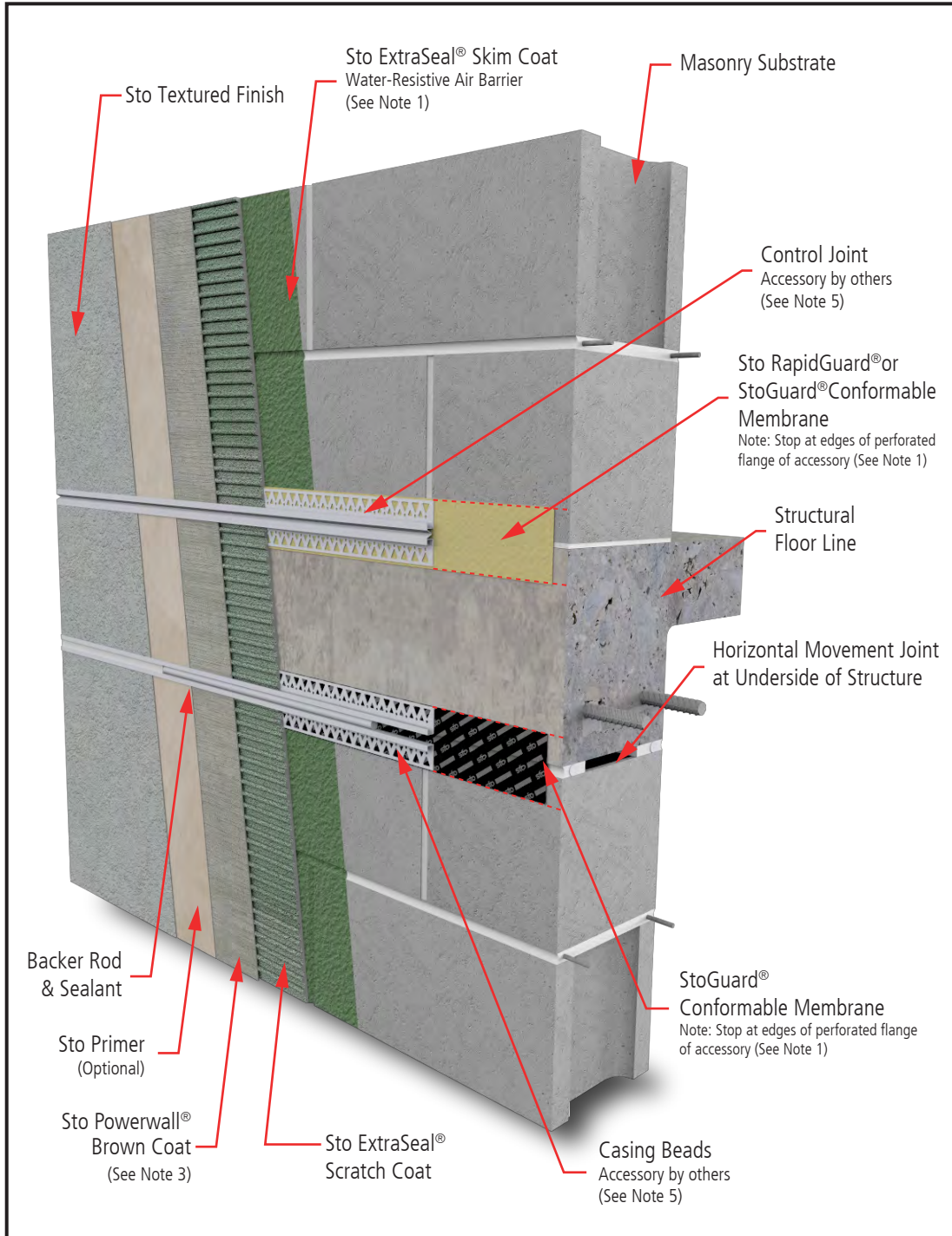

Notes:

1. Refer to StoGuard Product Use Chart (Table 1.1) for StoGuard detail components; joint treatment, rough opening protection, backing for masonry anchors, or transitions to dissimilar materials, joints and seams in construction.
2. Refer to General Notes for specific information and design guidance on wall assembly components.
3. Stucco brown coat material in compliance with ASTM C926 and manufactured or listed by Sto Corp.
4. Refer to applicable Sto guide specifications, product bulletins, Tech Hotlines, and other Sto guide details for additional information.
5. Components not identified as Sto are furnished by other manufacturers and are not necessarily installed by trades who install the Sto products. Refer to project specific contract documents.

ATTENTION

Property of Sto Corp. All Rights Reserved.

www.stocorp.com

Sto products are intended for use by qualified professional contractors, not consumers, as a component of a larger construction assembly as specified by a qualified design professional, general contractor or builder. They should be installed in accordance with those specifications and Sto's instructions. Sto Corp. disclaims all, and assumes no, liability for on-site inspections, for its products applied improperly, or by unqualified persons or entities, or as part of an improperly designed or constructed building, for the nonperformance of adjacent building components or assemblies, of for other construction activities beyond Sto's control. Improper use of Sto products or use as part of an improperly designed or constructed larger assembly or building may result in serious damage to Sto products, and to the structure of the building or its components.

STO CORP. DISCLAIMS ALL WARRANTIES EXPRESSED OR IMPLIED EXCEPT FOR EXPLICIT LIMITED WRITTEN WARRANTIES ISSUED TO AND ACCEPTED BY BUILDING OWNERS IN ACCORDANCE WITH STO'S WARRANTY PROGRAMS WHICH ARE SUBJECT TO CHANGE FROM TIME TO TIME. For the fullest, most current information on proper application, clean-up, mixing and other specifications and warranties, cautions and disclaimers, please refer to the Sto Corp. website, www.stocorp.com.



StoPowerwall® ExtraSeal® Rough Opening Protection

Detail No.: 65c.23
Date: January 2024
Page 1 of 2

Step 1

Apply Sto ExtraSeal® Skim Coat over complete surface to produce a void and pinhole free surface.

Let surface dry completely before applying Sto RapidGuard®

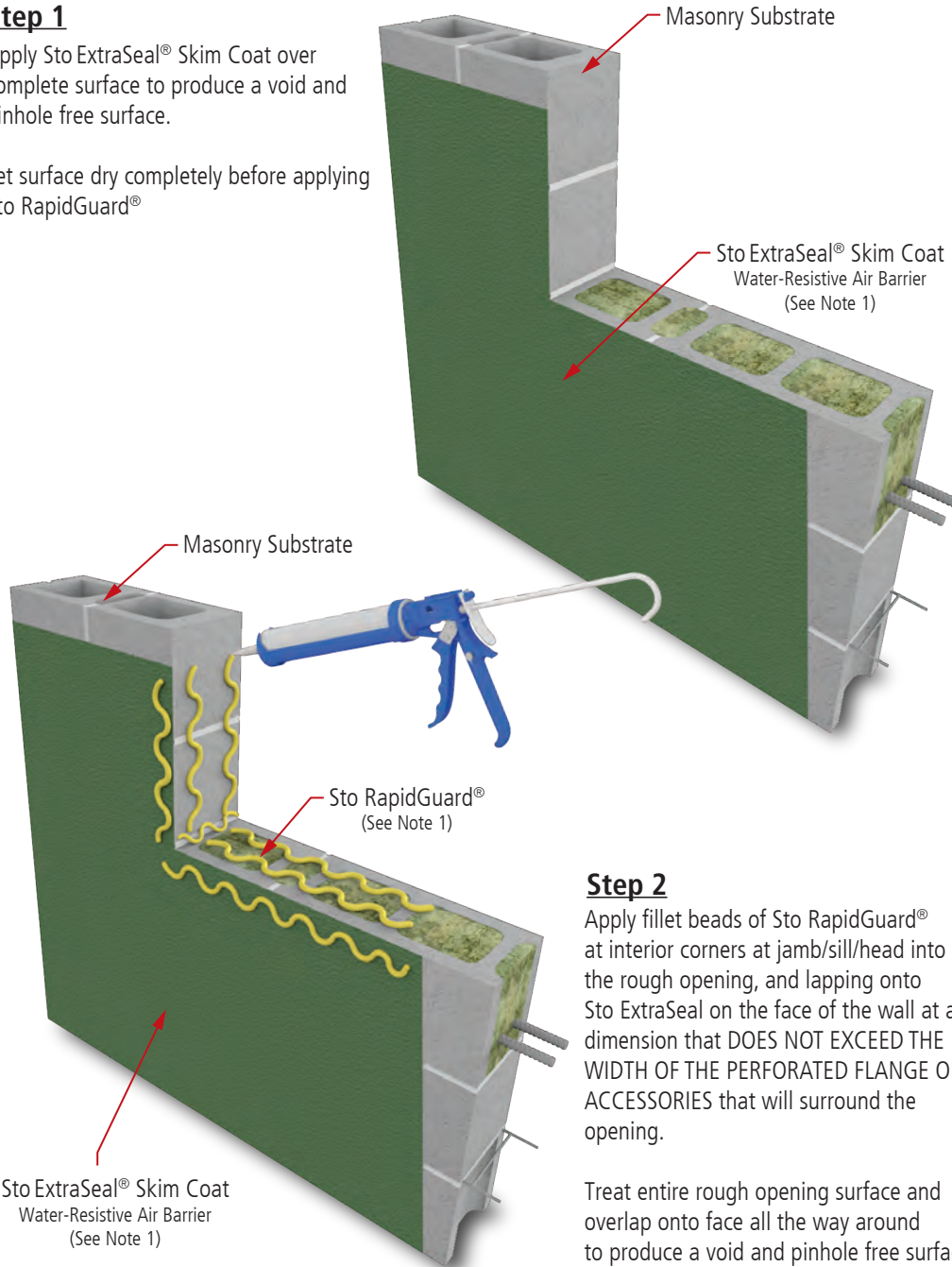

Step 2

Apply fillet beads of Sto RapidGuard® at interior corners at jamb/sill/head into the rough opening, and lapping onto Sto ExtraSeal on the face of the wall at a dimension that DOES NOT EXCEED THE WIDTH OF THE PERFORATED FLANGE OF ACCESSORIES that will surround the opening.

Treat entire rough opening surface and overlap onto face all the way around to produce a void and pinhole free surface.

Notes:

1. Refer to StoGuard Product Use Chart (Table 1.1) for StoGuard detail components; joint treatment, rough opening protection, backing for masonry anchors, or transitions to dissimilar materials, joints and seams in construction.
2. Refer to General Notes for specific information and design guidance on wall assembly components.
3. Stucco brown coat material in compliance with ASTM C926 and manufactured or listed by Sto Corp.
4. Refer to applicable Sto guide specifications, product bulletins, Tech Hotlines, and other Sto guide details for additional information.
5. Components not identified as Sto are furnished by other manufacturers and are not necessarily installed by trades who install the Sto products. Refer to project specific contract documents.

ATTENTION

Property of Sto Corp. All Rights Reserved.

Sto products are intended for use by qualified professional contractors, not consumers, as a component of a larger construction assembly as specified by a qualified design professional, general contractor or builder. They should be installed in accordance with those specifications and Sto's instructions. Sto Corp. disclaims all, and assumes no, liability for on-site inspections, for its products applied improperly, or by unqualified persons or entities, or as part of an improperly designed or constructed building, for the nonperformance of adjacent building components or assemblies, or for other construction activities beyond Sto's control. Improper use of Sto products or use as part of an improperly designed or constructed larger assembly or building may result in serious damage to Sto products, and to the structure of the building or its components.

STO CORP. DISCLAIMS ALL WARRANTIES EXPRESSED OR IMPLIED EXCEPT FOR EXPLICIT LIMITED WRITTEN WARRANTIES ISSUED TO AND ACCEPTED BY BUILDING OWNERS IN ACCORDANCE WITH STO'S WARRANTY PROGRAMS WHICH ARE SUBJECT TO CHANGE FROM TIME TO TIME. For the fullest, most current information on proper application, clean-up, mixing and other specifications and warranties, cautions and disclaimers, please refer to the Sto Corp. website, www.stocorp.com.

www.stocorp.com



StoPowerwall® ExtraSeal® Rough Opening Protection

Detail No.: 65c.23
Date: January 2024
Page 2 of 2

Step 3

Spread Sto RapidGuard® to a uniform wet film thickness of 12-20 mils to achieve a void and pinhole free surface, making sure NOT TO EXCEED THE WIDTH OF THE PERFORATED flange of the accessories that will surround the opening.

Inspect after drying and apply additional material where needed to produce a void and pinhole free surface.

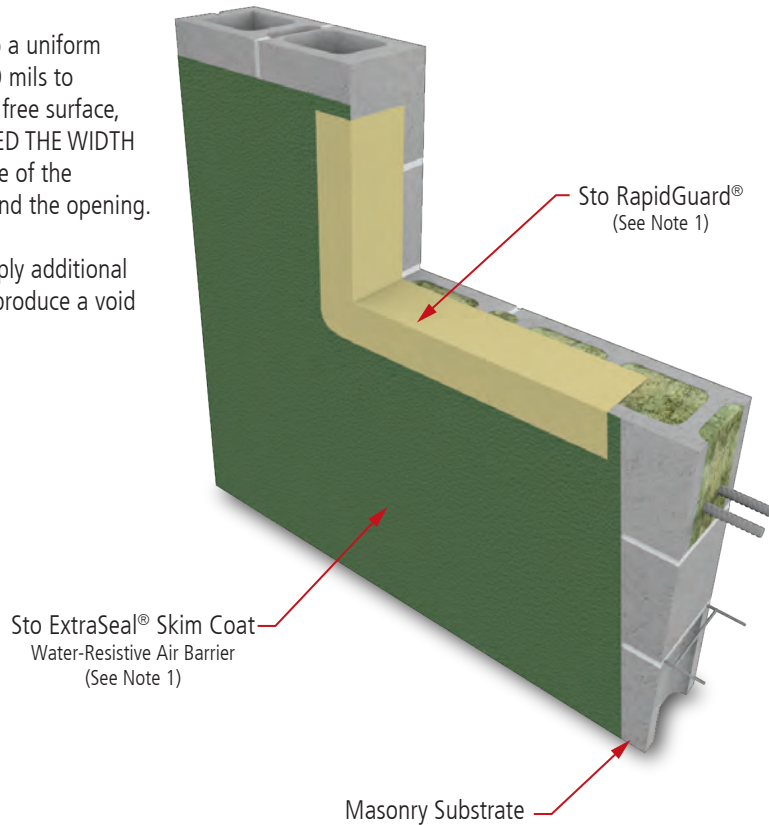

Notes:

1. Refer to StoGuard Product Use Chart (Table 1.1) for StoGuard detail components; joint treatment, rough opening protection, backing for masonry anchors, or transitions to dissimilar materials, joints and seams in construction.
2. Refer to General Notes for specific information and design guidance on wall assembly components.
3. Stucco brown coat material in compliance with ASTM C926 and manufactured or listed by Sto Corp.
4. Refer to applicable Sto guide specifications, product bulletins, Tech Hotlines, and other Sto guide details for additional information.
5. Components not identified as Sto are furnished by other manufacturers and are not necessarily installed by trades who install the Sto products. Refer to project specific contract documents.

ATTENTION

Property of Sto Corp. All Rights Reserved.

Sto products are intended for use by qualified professional contractors, not consumers, as a component of a larger construction assembly as specified by a qualified design professional, general contractor or builder. They should be installed in accordance with those specifications and Sto's instructions. Sto Corp. disclaims all, and assumes no, liability for on-site inspections, for its products applied improperly, or by unqualified persons or entities, or as part of an improperly designed or constructed building, for the nonperformance of adjacent building components or assemblies, or for other construction activities beyond Sto's control. Improper use of Sto products or use as part of an improperly designed or constructed larger assembly or building may result in serious damage to Sto products, and to the structure of the building or its components.

STO CORP. DISCLAIMS ALL WARRANTIES EXPRESSED OR IMPLIED EXCEPT FOR EXPLICIT LIMITED WRITTEN WARRANTIES ISSUED TO AND ACCEPTED BY BUILDING OWNERS IN ACCORDANCE WITH STO'S WARRANTY PROGRAMS WHICH ARE SUBJECT TO CHANGE FROM TIME TO TIME. For the fullest, most current information on proper application, clean-up, mixing and other specifications and warranties, cautions and disclaimers, please refer to the Sto Corp. website, www.stocorp.com.

www.stocorp.com



StoPowerwall® ExtraSeal® Box Window - Jamb and Sill

Detail No.: 65c.27
Date: January 2024

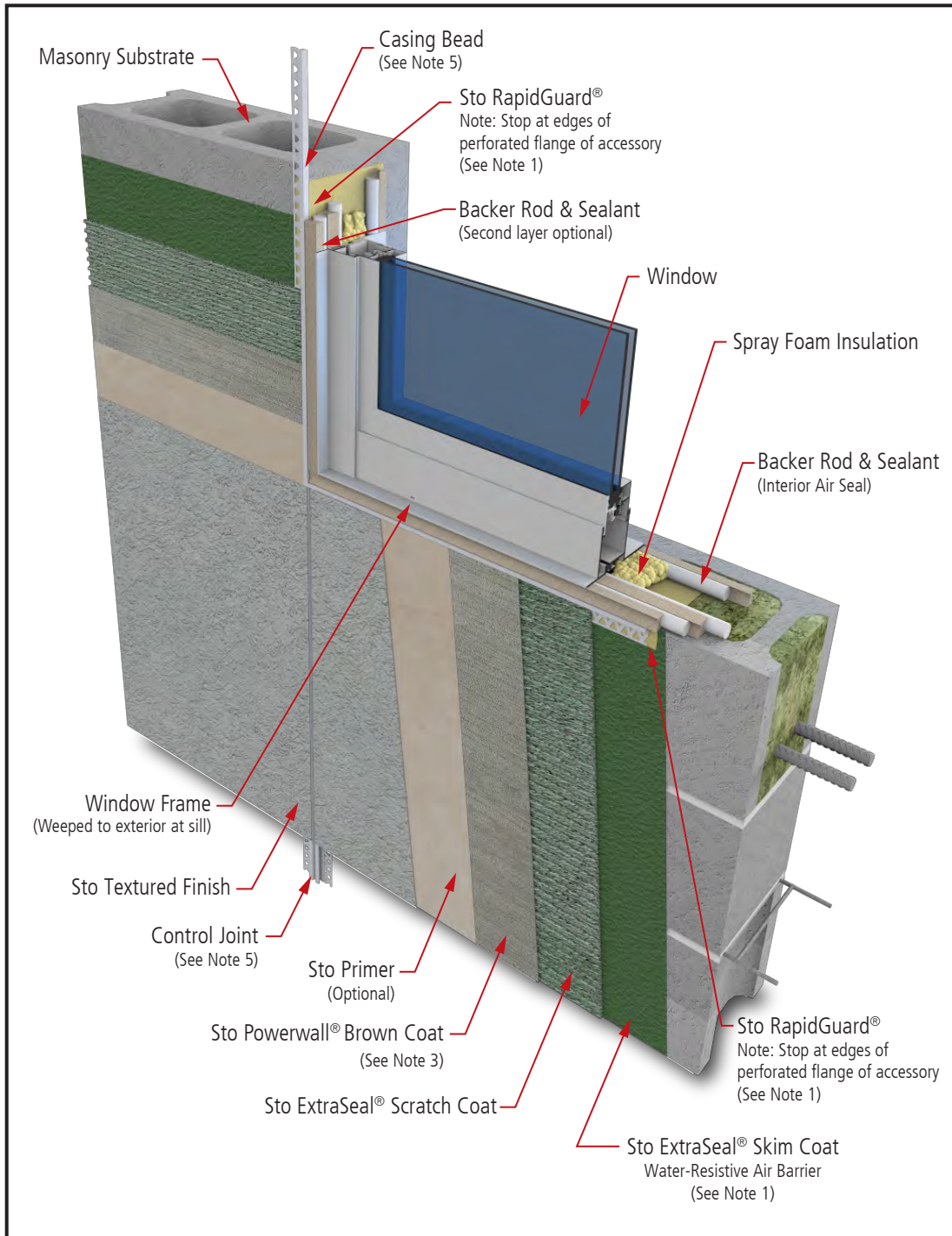

Notes:

1. Refer to StoGuard Product Use Chart (Table 1.1) for StoGuard detail components; joint treatment, rough opening protection, backing for masonry anchors, or transitions to dissimilar materials, joints and seams in construction.
2. Refer to General Notes for specific information and design guidance on wall assembly components.
3. Stucco brown coat material in compliance with ASTM C926 and manufactured or listed by Sto Corp.
4. The complete installation of window or mechanical equipment must include an air seal between the object and the StoGuard protection, inbound of the outer perimeter weather seal.
5. Refer to applicable Sto guide specifications, product bulletins, Tech Hotlines, and other Sto guide details for additional information.
6. Components not identified as Sto are furnished by other manufacturers and are not necessarily installed by trades who install the Sto products. Refer to project specific contract documents.

ATTENTION

Property of Sto Corp. All Rights Reserved.

Sto products are intended for use by qualified professional contractors, not consumers, as a component of a larger construction assembly as specified by a qualified design professional, general contractor or builder. They should be installed in accordance with those specifications and Sto's instructions. Sto Corp. disclaims all, and assumes no, liability for on-site inspections, for its products applied improperly, or by unqualified persons or entities, or as part of an improperly designed or constructed building, for the nonperformance of adjacent building components or assemblies, or for other construction activities beyond Sto's control. Improper use of Sto products or use as part of an improperly designed or constructed larger assembly or building may result in serious damage to Sto products, and to the structure of the building or its components.

STO CORP. DISCLAIMS ALL WARRANTIES EXPRESSED OR IMPLIED EXCEPT FOR EXPLICIT LIMITED WRITTEN WARRANTIES ISSUED TO AND ACCEPTED BY BUILDING OWNERS IN ACCORDANCE WITH STO'S WARRANTY PROGRAMS WHICH ARE SUBJECT TO CHANGE FROM TIME TO TIME. For the fullest, most current information on proper application, clean-up, mixing and other specifications and warranties, cautions and disclaimers, please refer to the Sto Corp. website, www.stocorp.com.

www.stocorp.com



StoPowerwall® ExtraSeal® Box Window - Head

Detail No.: 65c.28
Date: January 2024

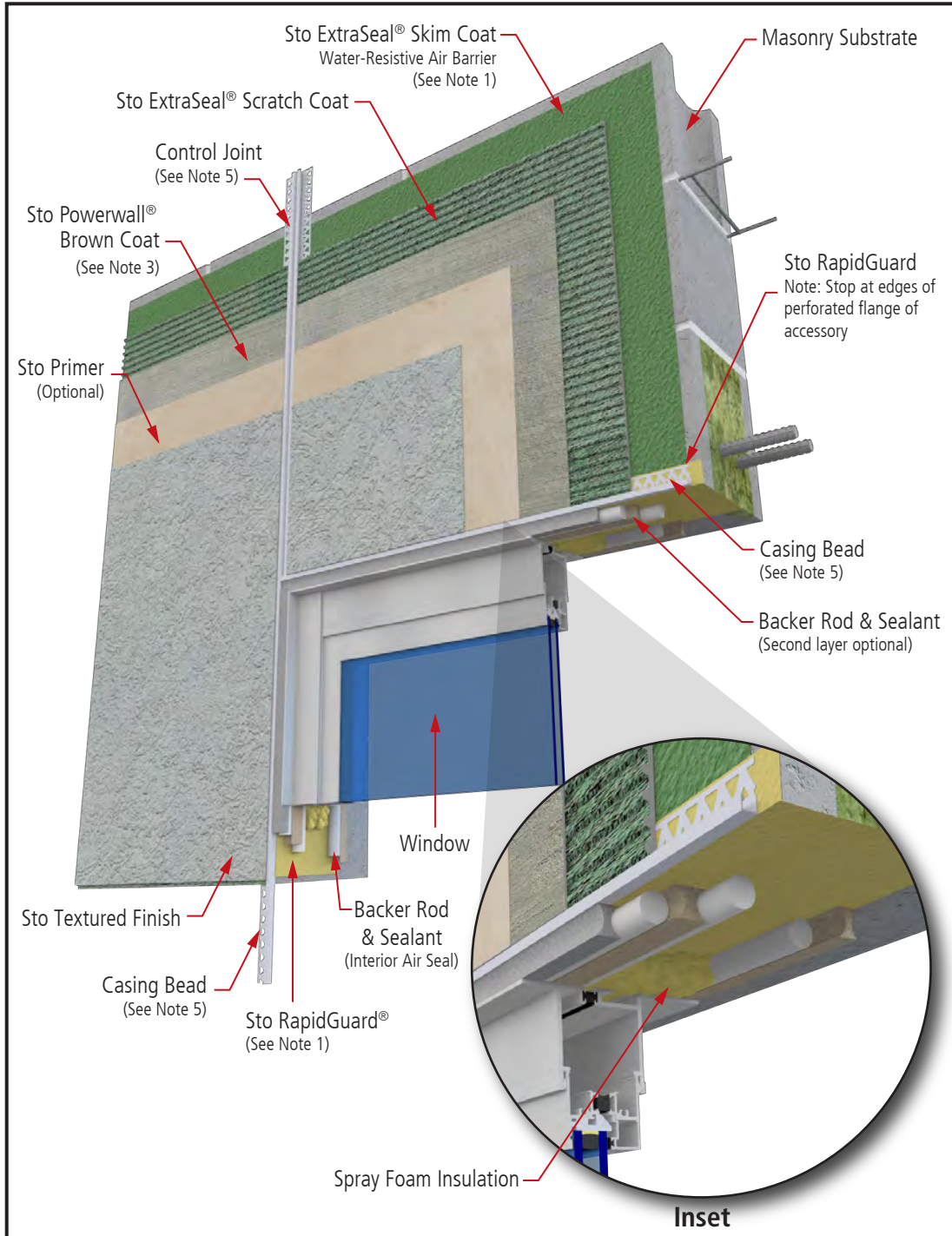

- Notes:**
1. Refer to StoGuard Product Use Chart (Table 1.1) for StoGuard detail components; joint treatment, rough opening protection, backing for masonry anchors, or transitions to dissimilar materials, joints and seams in construction.
 2. Refer to General Notes for specific information and design guidance on wall assembly components.
 3. Stucco brown coat material in compliance with ASTM C926 and manufactured or listed by Sto Corp.
 4. The complete installation of window or mechanical equipment must include an air seal between the object and the StoGuard protection, inbound of the outer perimeter weather seal.
 5. Refer to applicable Sto guide specifications, product bulletins, Tech Hotlines, and other Sto guide details for additional information.
 6. Components not identified as Sto are furnished by other manufacturers and are not necessarily installed by trades who install the Sto products. Refer to project specific contract documents.

ATTENTION

Sto products are intended for use by qualified professional contractors, not consumers, as a component of a larger construction assembly as specified by a qualified design professional, general contractor or builder. They should be installed in accordance with those specifications and Sto's instructions. Sto Corp. disclaims all, and assumes no, liability for on-site inspections, for its products applied improperly, or by unqualified persons or entities, or as part of an improperly designed or constructed building, for the nonperformance of adjacent building components or assemblies, of for other construction activities beyond Sto's control. Improper use of Sto products or use as part of an improperly designed or constructed larger assembly or building may result in serious damage to Sto products, and to the structure of the building or its components.

STO CORP. DISCLAIMS ALL WARRANTIES EXPRESSED OR IMPLIED EXCEPT FOR EXPLICIT LIMITED WRITTEN WARRANTIES ISSUED TO AND ACCEPTED BY BUILDING OWNERS IN ACCORDANCE WITH STO'S WARRANTY PROGRAMS WHICH ARE SUBJECT TO CHANGE FROM TIME TO TIME. For the fullest, most current information on proper application, clean-up, mixing and other specifications and warranties, cautions and disclaimers, please refer to the Sto Corp. website, www.stocorp.com.

Property of Sto Corp. All Rights Reserved.

www.stocorp.com



StoPowerwall® ExtraSeal® Soffit - Uninsulated Vented

Detail No.: 65c.30
Date: January 2024

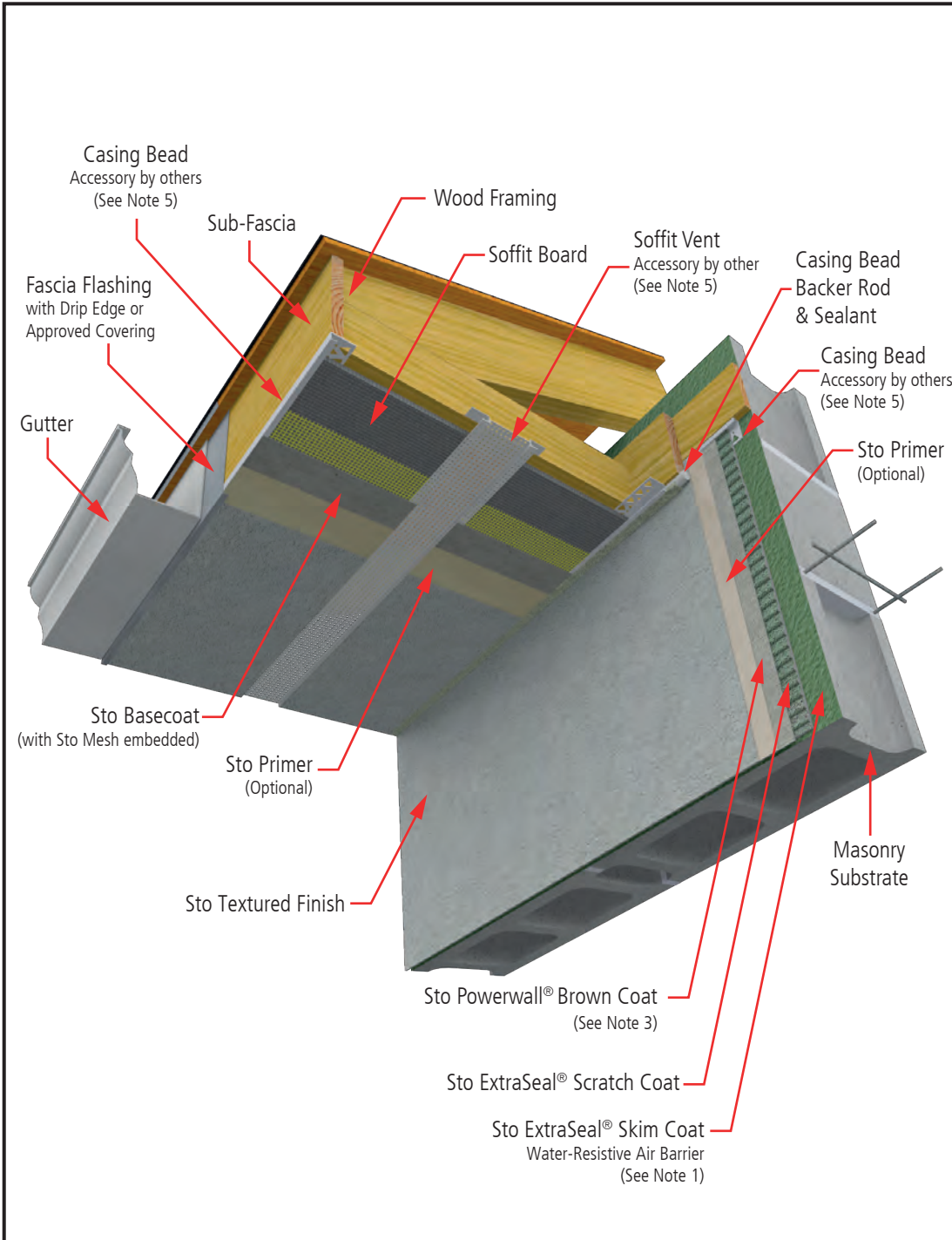

Notes:

1. Refer to StoGuard Product Use Chart (Table 1.1) for StoGuard detail components; joint treatment, rough opening protection, backing for masonry anchors, or transitions to dissimilar materials, joints and seams in construction.
2. Refer to General Notes for specific information and design guidance on wall assembly components.
3. Stucco brown coat material in compliance with ASTM C926 and manufactured or listed by Sto Corp.
4. Refer to applicable Sto guide specifications, product bulletins, Tech Hotlines, and other Sto guide details for additional information.
5. Components not identified as Sto are furnished by other manufacturers and are not necessarily installed by trades who install the Sto products. Refer to project specific contract documents.

ATTENTION

Property of Sto Corp. All Rights Reserved.

www.stocorp.com

Sto products are intended for use by qualified professional contractors, not consumers, as a component of a larger construction assembly as specified by a qualified design professional, general contractor or builder. They should be installed in accordance with those specifications and Sto's instructions. Sto Corp. disclaims all, and assumes no, liability for on-site inspections, for its products applied improperly, or by unqualified persons or entities, or as part of an improperly designed or constructed building, for the nonperformance of adjacent building components or assemblies, of for other construction activities beyond Sto's control. Improper use of Sto products or use as part of an improperly designed or constructed larger assembly or building may result in serious damage to Sto products, and to the structure of the building or its components.

STO CORP. DISCLAIMS ALL WARRANTIES EXPRESSED OR IMPLIED EXCEPT FOR EXPLICIT LIMITED WRITTEN WARRANTIES ISSUED TO AND ACCEPTED BY BUILDING OWNERS IN ACCORDANCE WITH STO'S WARRANTY PROGRAMS WHICH ARE SUBJECT TO CHANGE FROM TIME TO TIME. For the fullest, most current information on proper application, clean-up, mixing and other specifications and warranties, cautions and disclaimers, please refer to the Sto Corp. website, www.stocorp.com.



StoPowerwall® ExtraSeal® Unrestrained Joint at Dissimilar Material - Column Interface

Detail No.: 65c.41A
Date: January 2024

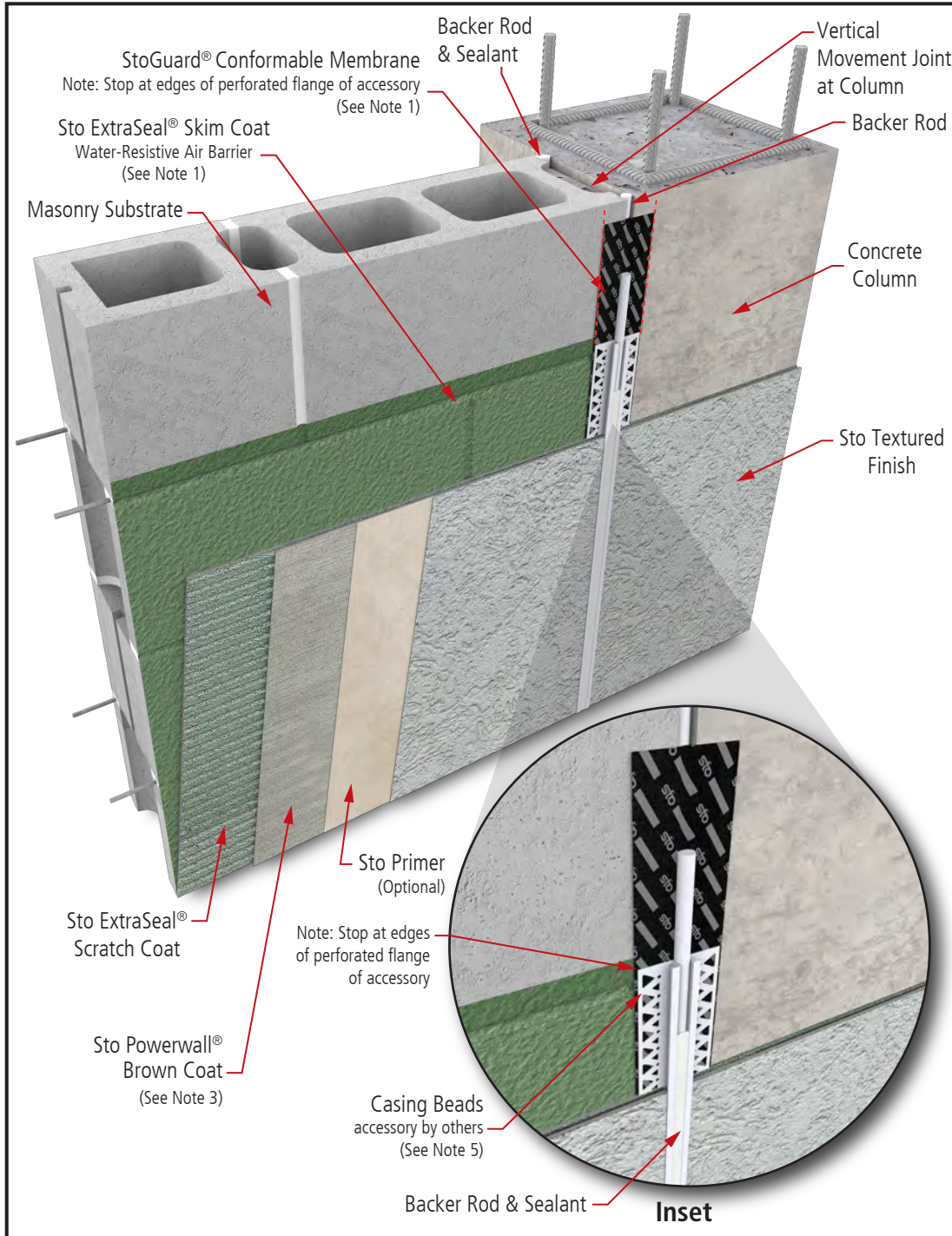

Notes:

1. Refer to StoGuard Product Use Chart (Table 1.1) for StoGuard detail components; joint treatment, rough opening protection, backing for masonry anchors, or transitions to dissimilar materials, joints and seams in construction.
2. Refer to General Notes for specific information and design guidance on wall assembly components.
3. Stucco brown coat material in compliance with ASTM C926 and manufactured or listed by Sto Corp.
4. Refer to applicable Sto guide specifications, product bulletins, Tech Hotlines, and other Sto guide details for additional information.
5. Components not identified as Sto are furnished by other manufacturers and are not necessarily installed by trades who install the Sto products. Refer to project specific contract documents.

ATTENTION

Property of Sto Corp. All Rights Reserved.

Sto products are intended for use by qualified professional contractors, not consumers, as a component of a larger construction assembly as specified by a qualified design professional, general contractor or builder. They should be installed in accordance with those specifications and Sto's instructions. Sto Corp. disclaims all, and assumes no, liability for on-site inspections, for its products applied improperly, or by unqualified persons or entities, or as part of an improperly designed or constructed building, for the nonperformance of adjacent building components or assemblies, or for other construction activities beyond Sto's control. Improper use of Sto products or use as part of an improperly designed or constructed larger assembly or building may result in serious damage to Sto products, and to the structure of the building or its components.

STO CORP. DISCLAIMS ALL WARRANTIES EXPRESSED OR IMPLIED EXCEPT FOR EXPLICIT LIMITED WRITTEN WARRANTIES ISSUED TO AND ACCEPTED BY BUILDING OWNERS IN ACCORDANCE WITH STO'S WARRANTY PROGRAMS WHICH ARE SUBJECT TO CHANGE FROM TIME TO TIME. For the fullest, most current information on proper application, clean-up, mixing and other specifications and warranties, cautions and disclaimers, please refer to the Sto Corp. website, www.stocorp.com.

www.stocorp.com



StoPowerwall® ExtraSeal® Restrained Joint at Dissimilar Material - Column Interface

Detail No.: 65c.41B
Date: January 2024

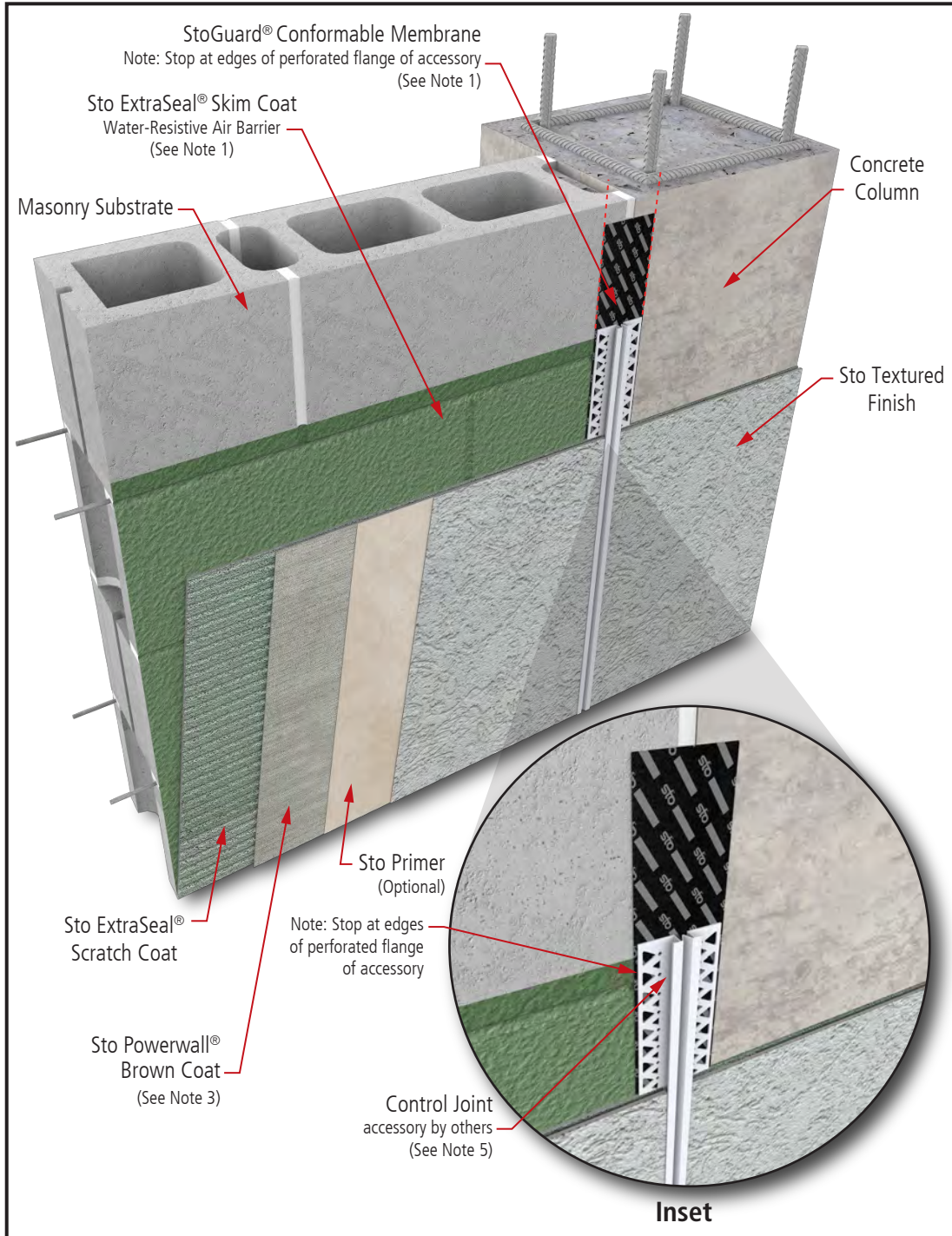

Notes:

1. Refer to StoGuard Product Use Chart (Table 1.1) for StoGuard detail components; joint treatment, rough opening protection, backing for masonry anchors, or transitions to dissimilar materials, joints and seams in construction.
2. Refer to General Notes for specific information and design guidance on wall assembly components.
3. Stucco brown coat material in compliance with ASTM C926 and manufactured or listed by Sto Corp.
4. Refer to applicable Sto guide specifications, product bulletins, Tech Hotlines, and other Sto guide details for additional information.
5. Components not identified as Sto are furnished by other manufacturers and are not necessarily installed by trades who install the Sto products. Refer to project specific contract documents.

ATTENTION

Property of Sto Corp. All Rights Reserved.

Sto products are intended for use by qualified professional contractors, not consumers, as a component of a larger construction assembly as specified by a qualified design professional, general contractor or builder. They should be installed in accordance with those specifications and Sto's instructions. Sto Corp. disclaims all, and assumes no, liability for on-site inspections, for its products applied improperly, or by unqualified persons or entities, or as part of an improperly designed or constructed building, for the nonperformance of adjacent building components or assemblies, or for other construction activities beyond Sto's control. Improper use of Sto products or use as part of an improperly designed or constructed larger assembly or building may result in serious damage to Sto products, and to the structure of the building or its components.

STO CORP. DISCLAIMS ALL WARRANTIES EXPRESSED OR IMPLIED EXCEPT FOR EXPLICIT LIMITED WRITTEN WARRANTIES ISSUED TO AND ACCEPTED BY BUILDING OWNERS IN ACCORDANCE WITH STO'S WARRANTY PROGRAMS WHICH ARE SUBJECT TO CHANGE FROM TIME TO TIME. For the fullest, most current information on proper application, clean-up, mixing and other specifications and warranties, cautions and disclaimers, please refer to the Sto Corp. website, www.stocorp.com.

www.stocorp.com



StoPowerwall® ExtraSeal® Aesthetic Feature

Detail No.: 65c.60
Date: January 2024

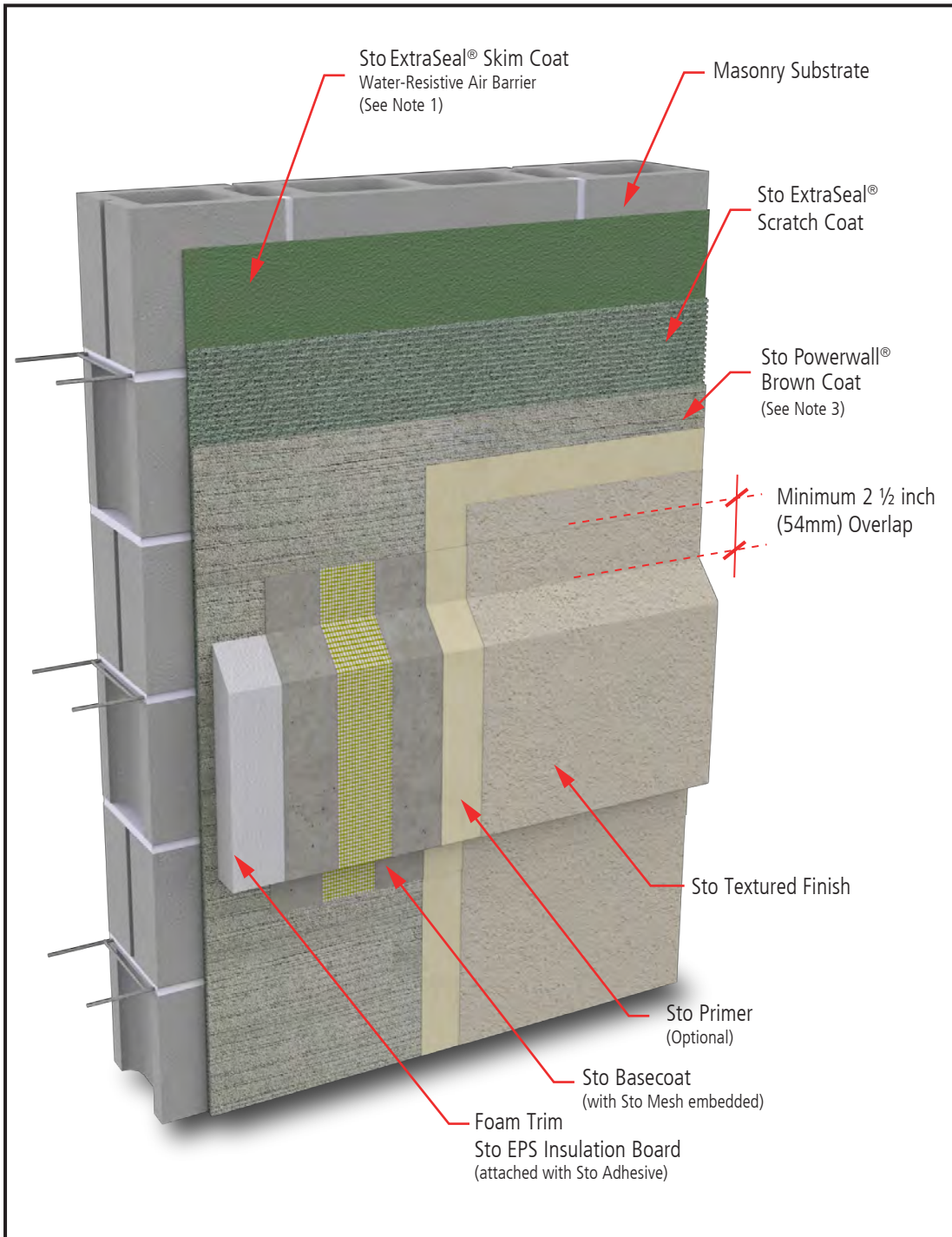

Notes:

1. Refer to StoGuard Product Use Chart (Table 1.1) for StoGuard detail components; joint treatment, rough opening protection, backing for masonry anchors, or transitions to dissimilar materials, joints and seams in construction.
2. Refer to General Notes for specific information and design guidance on wall assembly components.
3. Stucco brown coat material in compliance with ASTM C926 and manufactured or listed by Sto Corp.
4. Refer to applicable Sto guide specifications, product bulletins, Tech Hotlines, and other Sto guide details for additional information.
5. Components not identified as Sto are furnished by other manufacturers and are not necessarily installed by trades who install the Sto products. Refer to project specific contract documents.

ATTENTION

Property of Sto Corp. All Rights Reserved.

www.stocorp.com

Sto products are intended for use by qualified professional contractors, not consumers, as a component of a larger construction assembly as specified by a qualified design professional, general contractor or builder. They should be installed in accordance with those specifications and Sto's instructions. Sto Corp. disclaims all, and assumes no, liability for on-site inspections, for its products applied improperly, or by unqualified persons or entities, or as part of an improperly designed or constructed building, for the nonperformance of adjacent building components or assemblies, of for other construction activities beyond Sto's control. Improper use of Sto products or use as part of an improperly designed or constructed larger assembly or building may result in serious damage to Sto products, and to the structure of the building or its components.

STO CORP. DISCLAIMS ALL WARRANTIES EXPRESSED OR IMPLIED EXCEPT FOR EXPLICIT LIMITED WRITTEN WARRANTIES ISSUED TO AND ACCEPTED BY BUILDING OWNERS IN ACCORDANCE WITH STO'S WARRANTY PROGRAMS WHICH ARE SUBJECT TO CHANGE FROM TIME TO TIME. For the fullest, most current information on proper application, clean-up, mixing and other specifications and warranties, cautions and disclaimers, please refer to the Sto Corp. website, www.stocorp.com.



StoPowerwall® ExtraSeal® Small Pipe Penetration

Detail No.: 65c.70
Date: January 2024
Page 1 of 2

Step 1

Use Urethane Spray Foam or Sto TurboStick to fill gaps. Allow foam to cure properly before trimming flush with face of masonry substrate.

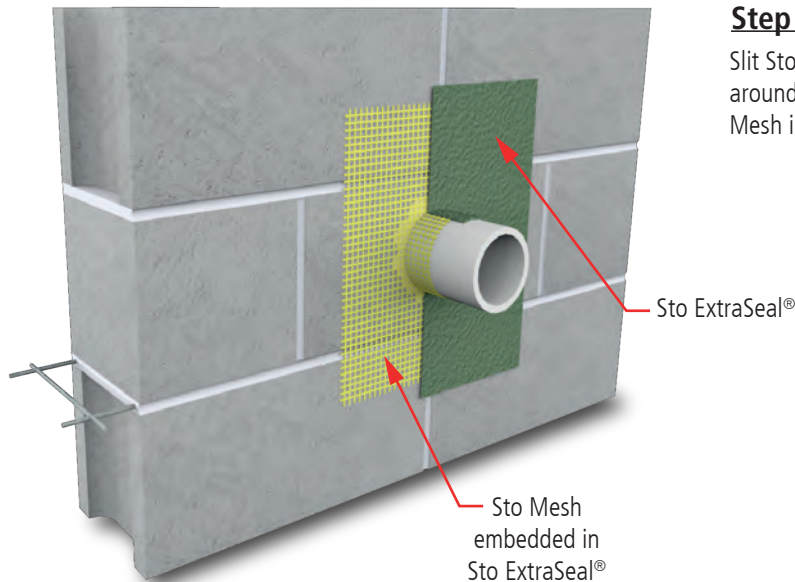
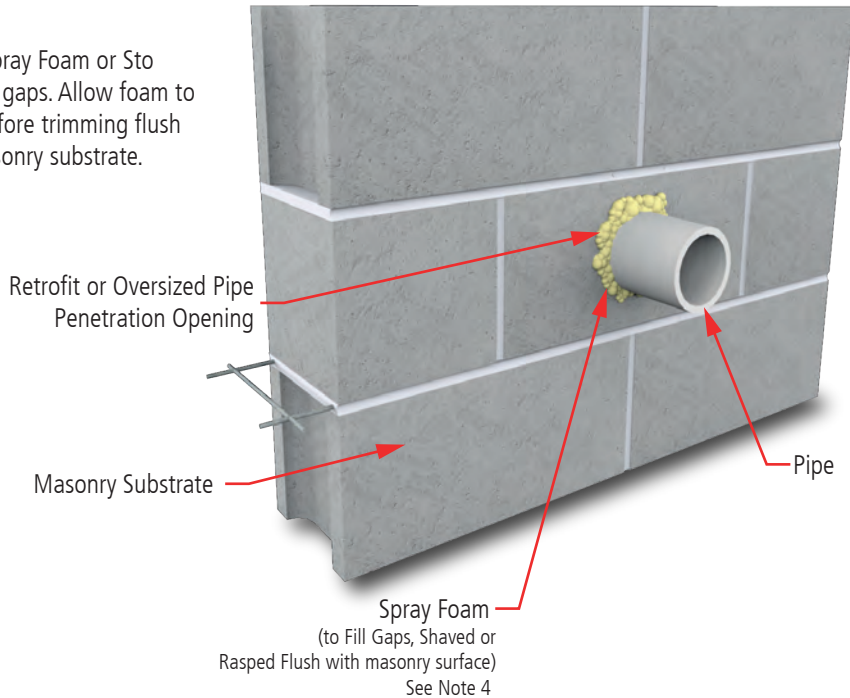

Step 2

Slit Sto Mesh in center to fit around pipe and embed Sto Mesh in Sto ExtraSeal.

Notes:

1. Refer to StoGuard Product Use Chart (Table 1.1) for StoGuard detail components; joint treatment, rough opening protection, backing for masonry anchors, or transitions to dissimilar materials, joints and seams in construction.
2. Refer to General Notes for specific information and design guidance on wall assembly components.
3. Stucco brown coat material in compliance with ASTM C926 and manufactured or listed by Sto Corp.
4. Consult Spray Foam manufacturer for maximum size of gap for product being used.
5. Refer to applicable Sto guide specifications, product bulletins, Tech Hotlines, and other Sto guide details for additional information.
6. Components not identified as Sto are furnished by other manufacturers and are not necessarily installed by trades who install the Sto products. Refer to project specific contract documents.

ATTENTION

Property of Sto Corp. All Rights Reserved.

www.stocorp.com

Sto products are intended for use by qualified professional contractors, not consumers, as a component of a larger construction assembly as specified by a qualified design professional, general contractor or builder. They should be installed in accordance with those specifications and Sto's instructions. Sto Corp. disclaims all, and assumes no, liability for on-site inspections, for its products applied improperly, or by unqualified persons or entities, or as part of an improperly designed or constructed building, for the nonperformance of adjacent building components or assemblies, of for other construction activities beyond Sto's control. Improper use of Sto products or use as part of an improperly designed or constructed larger assembly or building may result in serious damage to Sto products, and to the structure of the building or its components.

STO CORP. DISCLAIMS ALL WARRANTIES EXPRESSED OR IMPLIED EXCEPT FOR EXPLICIT LIMITED WRITTEN WARRANTIES ISSUED TO AND ACCEPTED BY BUILDING OWNERS IN ACCORDANCE WITH STO'S WARRANTY PROGRAMS WHICH ARE SUBJECT TO CHANGE FROM TIME TO TIME. For the fullest, most current information on proper application, clean-up, mixing and other specifications and warranties, cautions and disclaimers, please refer to the Sto Corp. website, www.stocorp.com.



StoPowerwall® ExtraSeal® Small Pipe Penetration

Detail No.: 65c.70
Date: January 2024
Page 2 of 2

Step 3

After applying Sto ExtraSeal® Scratch Coat and Sto Powerwall® Brown Coat around the pipe, install self-adhesive quarter round Backer Rod around the pipe against the Brown Coat and pipe, followed by Sealant.

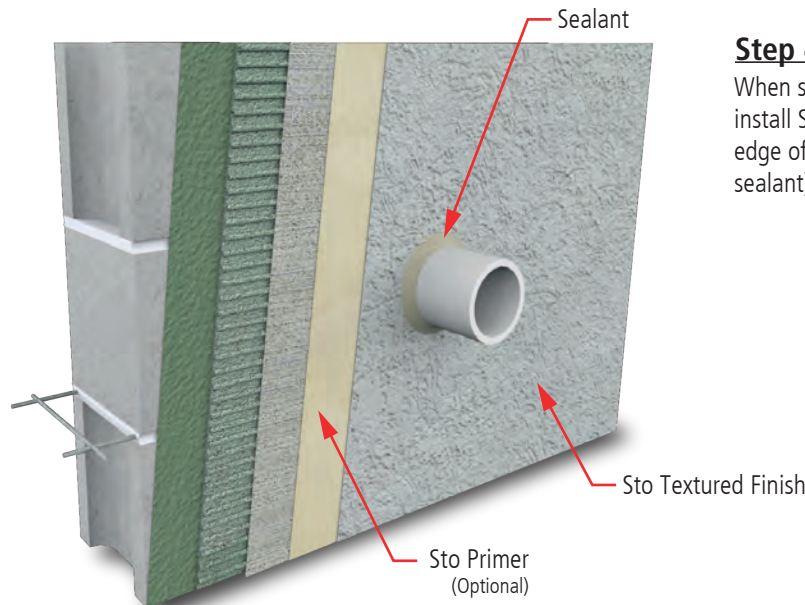
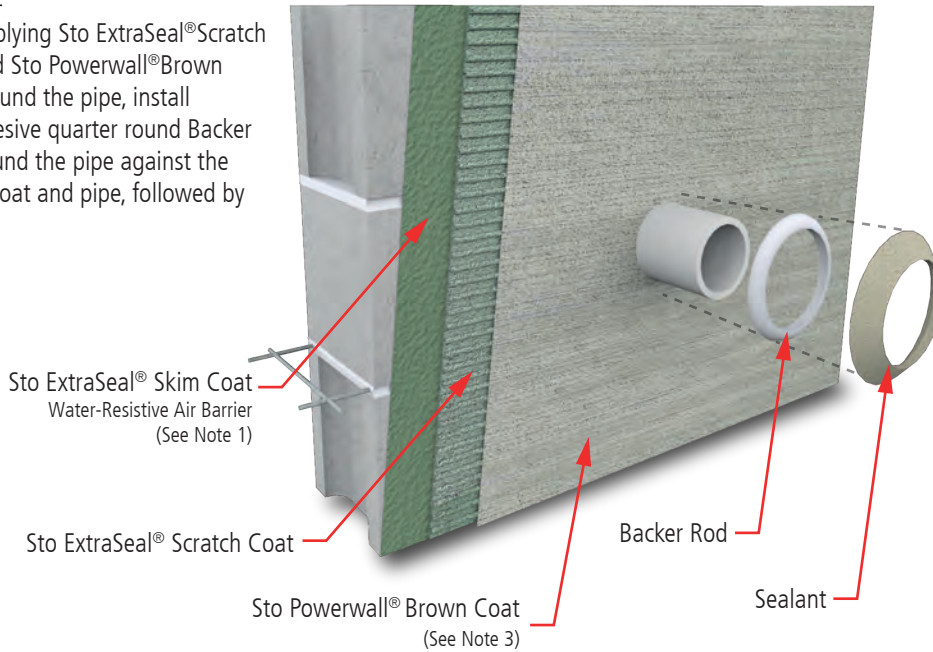

Step 4

When sealant is fully cured, install Sto Textured Finish up to edge of sealant (not over sealant).

Notes:

1. Refer to StoGuard Product Use Chart (Table 1.1) for StoGuard detail components; joint treatment, rough opening protection, backing for masonry anchors, or transitions to dissimilar materials, joints and seams in construction.
2. Refer to General Notes for specific information and design guidance on wall assembly components.
3. Stucco brown coat material in compliance with ASTM C926 and manufactured or listed by Sto Corp.
4. Consult Spray Foam manufacturer for maximum size of gap for product being used.
5. Refer to applicable Sto guide specifications, product bulletins, Tech Hotlines, and other Sto guide details for additional information.
6. Components not identified as Sto are furnished by other manufacturers and are not necessarily installed by trades who install the Sto products. Refer to project specific contract documents.

ATTENTION

Property of Sto Corp. All Rights Reserved.

www.stocorp.com

Sto products are intended for use by qualified professional contractors, not consumers, as a component of a larger construction assembly as specified by a qualified design professional, general contractor or builder. They should be installed in accordance with those specifications and Sto's instructions. Sto Corp. disclaims all, and assumes no, liability for on-site inspections, for its products applied improperly, or by unqualified persons or entities, or as part of an improperly designed or constructed building, for the nonperformance of adjacent building components or assemblies, of for other construction activities beyond Sto's control. Improper use of Sto products or use as part of an improperly designed or constructed larger assembly or building may result in serious damage to Sto products, and to the structure of the building or its components.

STO CORP. DISCLAIMS ALL WARRANTIES EXPRESSED OR IMPLIED EXCEPT FOR EXPLICIT LIMITED WRITTEN WARRANTIES ISSUED TO AND ACCEPTED BY BUILDING OWNERS IN ACCORDANCE WITH STO'S WARRANTY PROGRAMS WHICH ARE SUBJECT TO CHANGE FROM TIME TO TIME. For the fullest, most current information on proper application, clean-up, mixing and other specifications and warranties, cautions and disclaimers, please refer to the Sto Corp. website, www.stocorp.com.



StoPowerwall® ExtraSeal® Parapet - Front

Detail No.: 65c.81
Date: January 2024
Page 1 of 2

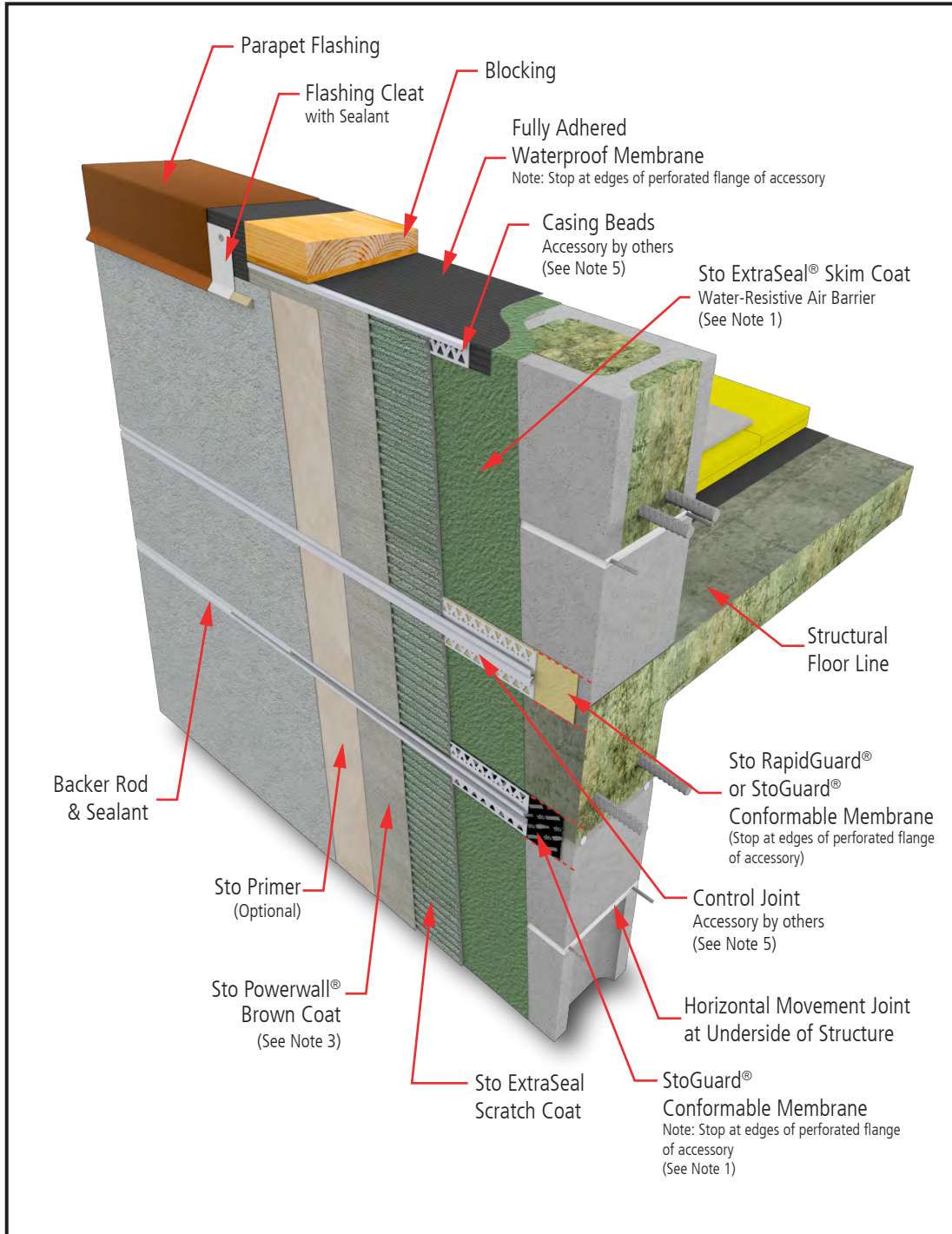

- Notes:**
1. Refer to StoGuard Product Use Chart (Table 1.1) for StoGuard detail components; joint treatment, rough opening protection, backing for masonry anchors, or transitions to dissimilar materials, joints and seams in construction.
 2. Refer to General Notes for specific information and design guidance on wall assembly components.
 3. Stucco brown coat material in compliance with ASTM C926 and manufactured or listed by Sto Corp.
 4. Refer to applicable Sto guide specifications, product bulletins, Tech Hotlines, and other Sto guide details for additional information.
 5. Components not identified as Sto are furnished by other manufacturers and are not necessarily installed by trades who install the Sto products. Refer to project specific contract documents.

ATTENTION

Property of Sto Corp. All Rights Reserved.

www.stocorp.com

Sto products are intended for use by qualified professional contractors, not consumers, as a component of a larger construction assembly as specified by a qualified design professional, general contractor or builder. They should be installed in accordance with those specifications and Sto's instructions. Sto Corp. disclaims all, and assumes no, liability for on-site inspections, for its products applied improperly, or by unqualified persons or entities, or as part of an improperly designed or constructed building, for the nonperformance of adjacent building components or assemblies, of for other construction activities beyond Sto's control. Improper use of Sto products or use as part of an improperly designed or constructed larger assembly or building may result in serious damage to Sto products, and to the structure of the building or its components.

STO CORP. DISCLAIMS ALL WARRANTIES EXPRESSED OR IMPLIED EXCEPT FOR EXPLICIT LIMITED WRITTEN WARRANTIES ISSUED TO AND ACCEPTED BY BUILDING OWNERS IN ACCORDANCE WITH STO'S WARRANTY PROGRAMS WHICH ARE SUBJECT TO CHANGE FROM TIME TO TIME. For the fullest, most current information on proper application, clean-up, mixing and other specifications and warranties, cautions and disclaimers, please refer to the Sto Corp. website, www.stocorp.com.



StoPowerwall® ExtraSeal® Parapet - Back

Detail No.: 65c.81
Date: January 2024
Page 2 of 2

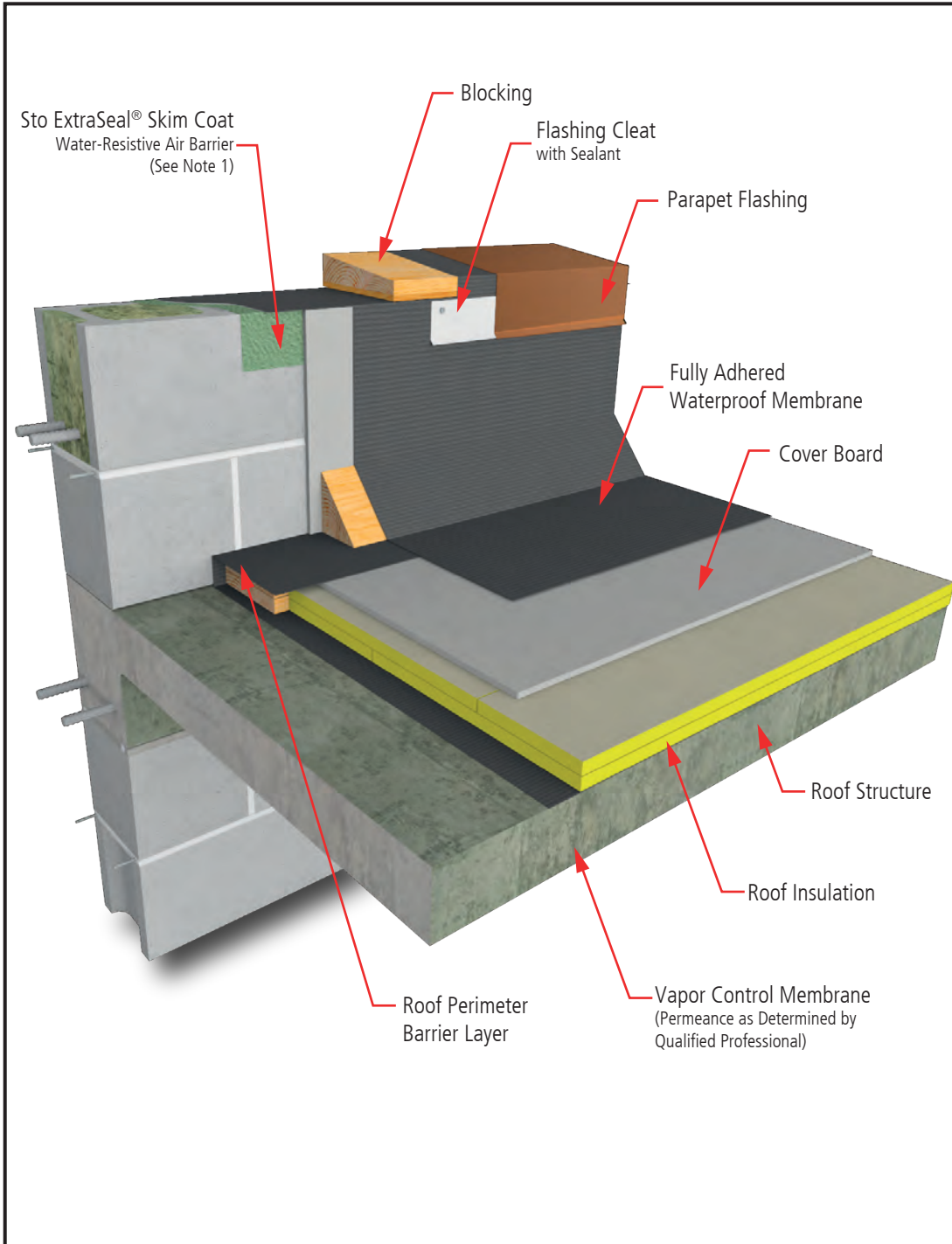

Notes:

1. Refer to StoGuard Product Use Chart (Table 1.1) for StoGuard detail components; joint treatment, rough opening protection, backing for masonry anchors, or transitions to dissimilar materials, joints and seams in construction.
2. Refer to General Notes for specific information and design guidance on wall assembly components.
3. Stucco brown coat material in compliance with ASTM C926 and manufactured or listed by Sto Corp.
4. Refer to applicable Sto guide specifications, product bulletins, Tech Hotlines, and other Sto guide details for additional information.
5. Components not identified as Sto are furnished by other manufacturers and are not necessarily installed by trades who install the Sto products. Refer to project specific contract documents.

ATTENTION

Property of Sto Corp. All Rights Reserved.

www.stocorp.com

Sto products are intended for use by qualified professional contractors, not consumers, as a component of a larger construction assembly as specified by a qualified design professional, general contractor or builder. They should be installed in accordance with those specifications and Sto's instructions. Sto Corp. disclaims all, and assumes no, liability for on-site inspections, for its products applied improperly, or by unqualified persons or entities, or as part of an improperly designed or constructed building, for the nonperformance of adjacent building components or assemblies, of for other construction activities beyond Sto's control. Improper use of Sto products or use as part of an improperly designed or constructed larger assembly or building may result in serious damage to Sto products, and to the structure of the building or its components.

STO CORP. DISCLAIMS ALL WARRANTIES EXPRESSED OR IMPLIED EXCEPT FOR EXPLICIT LIMITED WRITTEN WARRANTIES ISSUED TO AND ACCEPTED BY BUILDING OWNERS IN ACCORDANCE WITH STO'S WARRANTY PROGRAMS WHICH ARE SUBJECT TO CHANGE FROM TIME TO TIME. For the fullest, most current information on proper application, clean-up, mixing and other specifications and warranties, cautions and disclaimers, please refer to the Sto Corp. website, www.stocorp.com.

