

StoQuik[®] Finish System for ICF Insulated Concrete Forms

Detail Booklet

Series 17.xx | November 2022

Facades



Direct Applied
Finish Systems (DEFS)

StoQuik[®] Finish System for Insulated Concrete Forms (ICF) is a decorative and protective direct applied, above grade, acrylic based textured finish system over ASTM C 578 Type I, II, or IV compliant molded EPS insulation wall forms. Sto's high performance finishes provide a handsome aesthetic and a durable exterior skin.

StoQuik[®] Finish System for Insulated Concrete Forms can be used in residential or commercial wall construction.



Details

Components	17.01
Components: High Impact Resistance	17.02
Features	17.06
Interior Foundation Projections	17.10
Below Grade Components	17.11
Residential Window Sill	17.23
Finished Opening Sill	17.25



ATTENTION

The final design of any project is the sole responsibility of the Design Professional, with considerations for compliance with local building and design codes and requirements. Sto Corp. accepts no liability for design, engineering, or workmanship of any project. The information provided herein is in addition to other technical data provided by Sto Corp. (System Bulletin, Specification, Guide Details, etc). For more information, please visit www.stocorp.com

Sto Corp.

3800 Camp Creek Pkwy. SW
Bldg. 1400 • Suite 120
Atlanta, GA 30331
Tel: (800) 221-2397
Fax: (404) 346-3119
<http://www.stocorp.com>
helpdesk.stocorp.com

StoQuik® Finish System for Insulated Concrete Forms (ICF) Components

Detail No.: 17.01
Date: November 2022

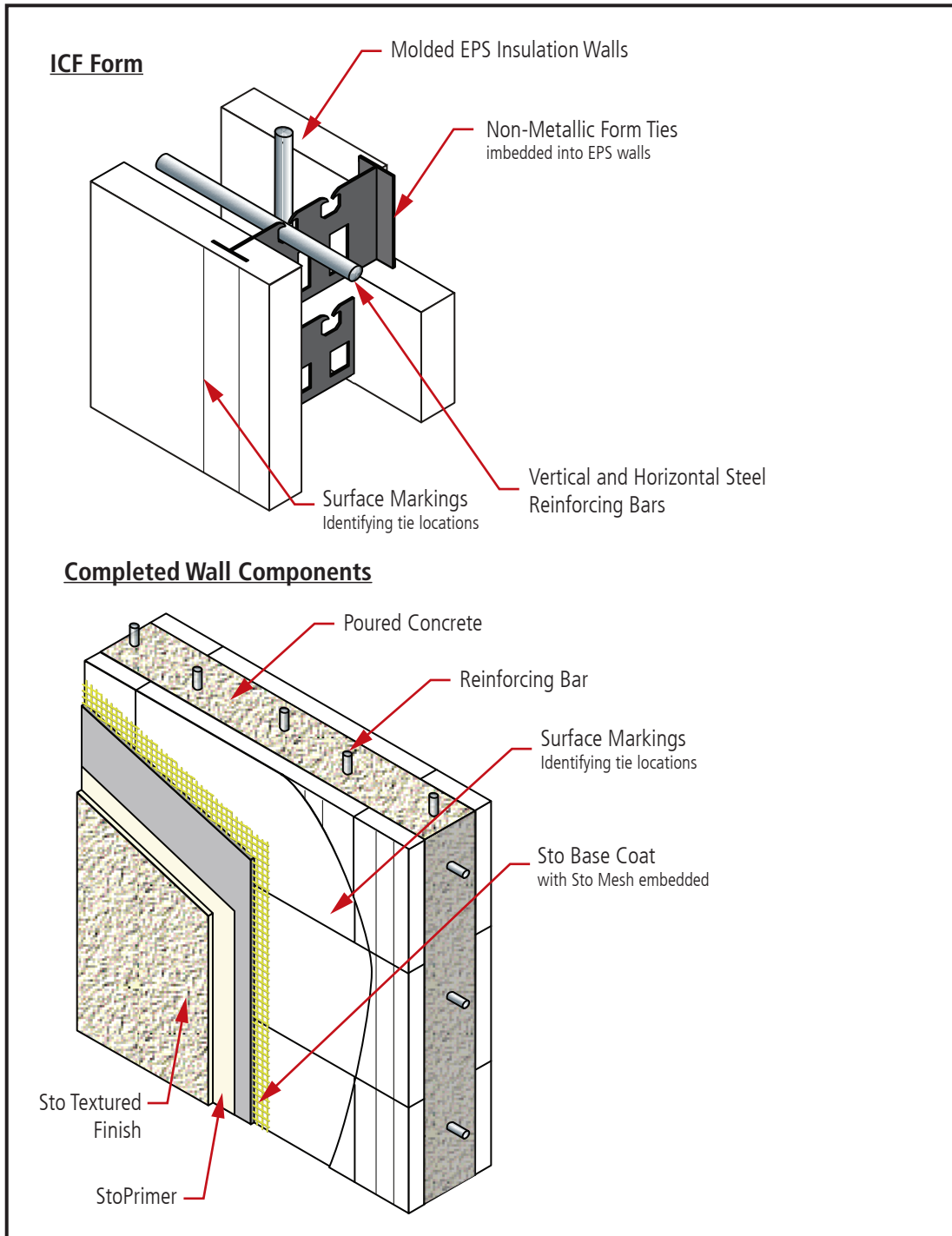

Notes:

1. Refer to System Specifications and System Bulletin for more information and design guidance on wall assembly components.
2. Forms suitable for direct application coatings have imbedded, non-metallic form ties positioned a minimum 1/2" (13 mm) from the outer surface.
3. The forms are molded 1.5 pcf, Expanded Polystyrene insulation (EPS)
4. Rasping the foam surface to provide a level surface for coatings shall not expose the form ties.
5. ICFs that differ from the above may be completed by adding:
 - a) 1" (25 mm) EPS insulation and EIFS coatings
 - b) Metal Lath and StoPowerwall Stucco, Sto Primer and Sto Finish.
6. Concrete shall be allowed to cure for a minimum of 28 days prior to application of Sto coating materials.
7. Components not identified as Sto are furnished by other manufacturers and are not necessarily installed by trades who install the Sto products. Refer to project specific contract documents.

ATTENTION

Property of Sto Corp. All Rights Reserved.

Sto products are intended for use by qualified professional contractors, not consumers, as a component of a larger construction assembly as specified by a qualified design professional, general contractor or builder. They should be installed in accordance with those specifications and Sto's instructions. Sto Corp. disclaims all, and assumes no, liability for on-site inspections, for its products applied improperly, or by unqualified persons or entities, or as part of an improperly designed or constructed building, for the nonperformance of adjacent building components or assemblies, or for other construction activities beyond Sto's control. Improper use of Sto products or use as part of an improperly designed or constructed larger assembly or building may result in serious damage to Sto products, and to the structure of the building or its components.

STO CORP. DISCLAIMS ALL WARRANTIES EXPRESSED OR IMPLIED EXCEPT FOR EXPLICIT LIMITED WRITTEN WARRANTIES ISSUED TO AND ACCEPTED BY BUILDING OWNERS IN ACCORDANCE WITH STO'S WARRANTY PROGRAMS WHICH ARE SUBJECT TO CHANGE FROM TIME TO TIME. For the fullest, most current information on proper application, clean-up, mixing and other specifications and warranties, cautions and disclaimers, please refer to the Sto Corp. website, www.stocorp.com.

www.stocorp.com



StoQuik® Finish System for Insulated Concrete Forms (ICF) Components: High Impact Resistance

Detail No.: 17.02
Date: November 2022

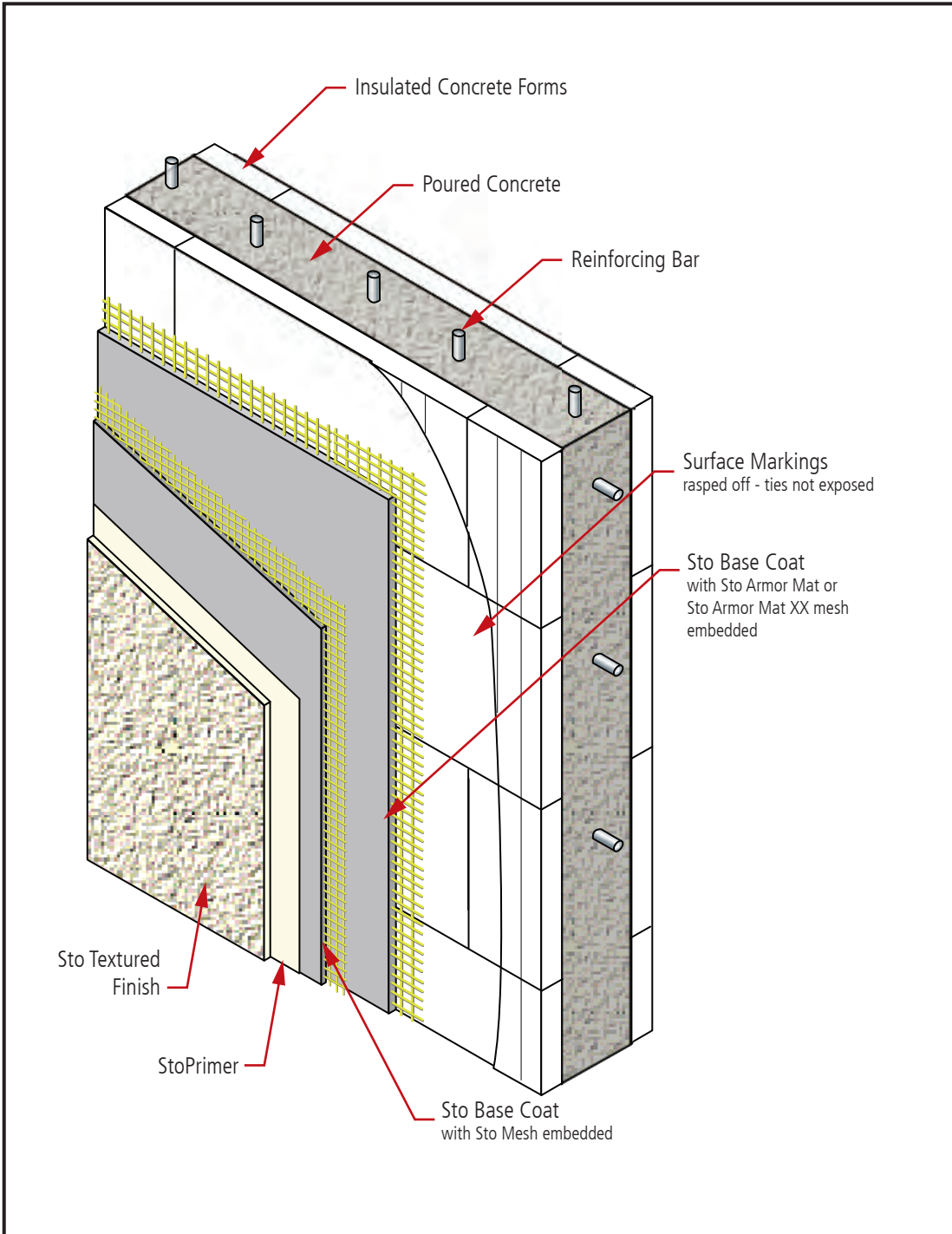

- Notes:**
1. Refer to System Specifications and System Bulletin for more information and design guidance on wall assembly components.
 2. Apply Sto Base Coat and immediately trowel in Sto Armor Mat or Sto XX Armor Mat as per Sto specifications. Allow to cure a minimum 24 hours.
 3. Concrete shall be allowed to cure for a minimum of 28 days prior to application of Sto coating materials.
 4. Components not identified as Sto are furnished by other manufacturers and are not necessarily installed by trades who install the Sto products. Refer to project specific contract documents.

ATTENTION

Property of Sto Corp. All Rights Reserved.

www.stocorp.com

Sto products are intended for use by qualified professional contractors, not consumers, as a component of a larger construction assembly as specified by a qualified design professional, general contractor or builder. They should be installed in accordance with those specifications and Sto's instructions. Sto Corp. disclaims all, and assumes no, liability for on-site inspections, for its products applied improperly, or by unqualified persons or entities, or as part of an improperly designed or constructed building, for the nonperformance of adjacent building components or assemblies, or for other construction activities beyond Sto's control. Improper use of Sto products or use as part of an improperly designed or constructed larger assembly or building may result in serious damage to Sto products, and to the structure of the building or its components.

STO CORP. DISCLAIMS ALL WARRANTIES EXPRESSED OR IMPLIED EXCEPT FOR EXPLICIT LIMITED WRITTEN WARRANTIES ISSUED TO AND ACCEPTED BY BUILDING OWNERS IN ACCORDANCE WITH STO'S WARRANTY PROGRAMS WHICH ARE SUBJECT TO CHANGE FROM TIME TO TIME. For the fullest, most current information on proper application, clean-up, mixing and other specifications and warranties, cautions and disclaimers, please refer to the Sto Corp. website, www.stocorp.com.



StoQuik® Finish System for Insulated Concrete Forms (ICF) Features

Detail No.: 17.06

Date: November 2022

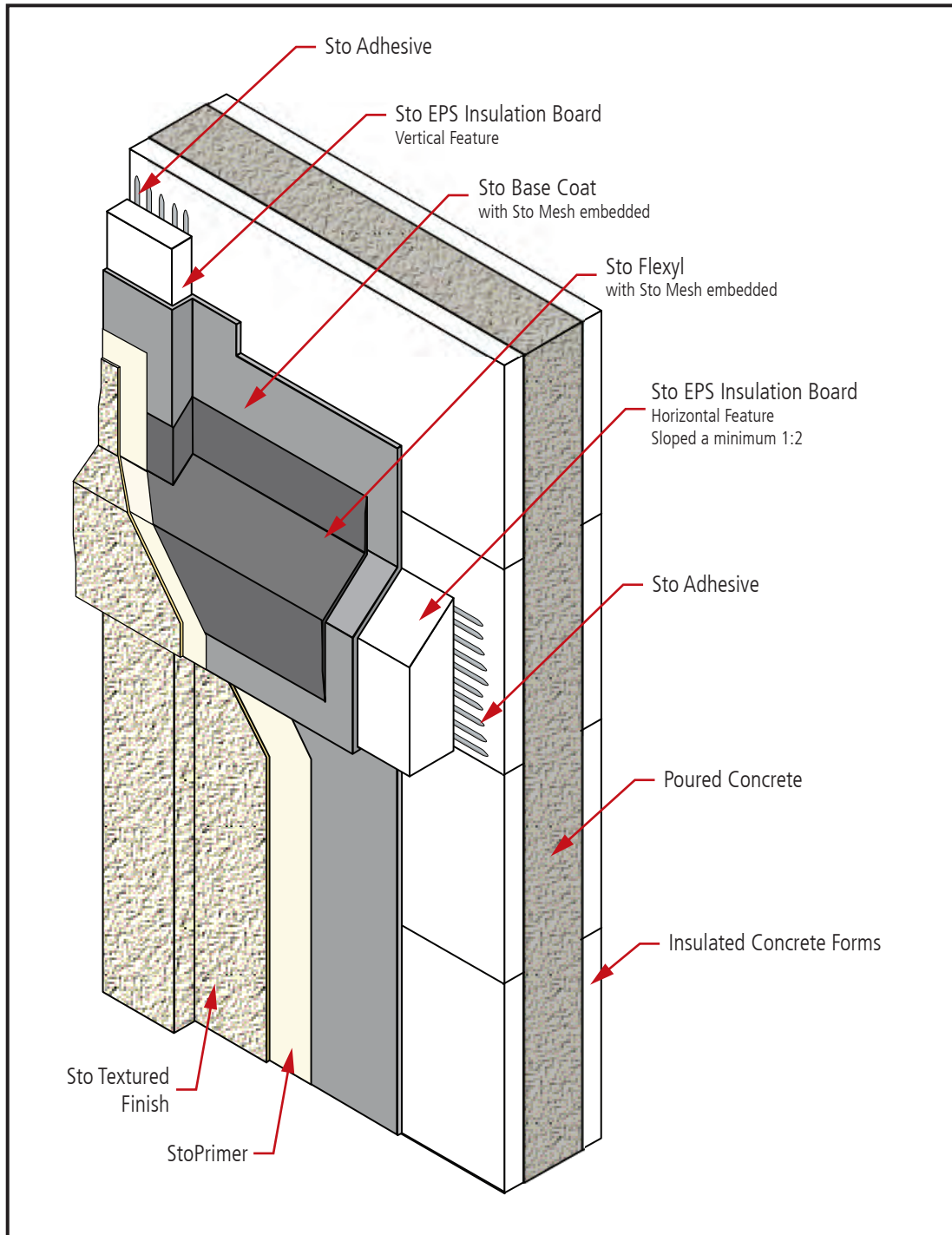

Notes:

1. Refer to System Specifications and System Bulletin for more information and design guidance on wall assembly components.
2. Add features using Sto EPS Insulation Board foam shapes bonded to the ICFs with Sto BTS Plus, Primer/Adhesive-B or Sto Dispersion Adhesive.
3. Install Sto Flexyl and Sto Mesh over weather exposed sloped surfaces and lapping onto the vertical surface 4" to 6" (100 to 150 mm). Sto Watertight Coat is an acceptable substitute for Sto Flexyl.
4. Components not identified as Sto are furnished by other manufacturers and are not necessarily installed by trades who install the Sto products. Refer to project specific contract documents.

ATTENTION

Sto products are intended for use by qualified professional contractors, not consumers, as a component of a larger construction assembly as specified by a qualified design professional, general contractor or builder. They should be installed in accordance with those specifications and Sto's instructions. Sto Corp. disclaims all, and assumes no, liability for on-site inspections, for its products applied improperly, or by unqualified persons or entities, or as part of an improperly designed or constructed building, for the nonperformance of adjacent building components or assemblies, or for other construction activities beyond Sto's control. Improper use of Sto products or use as part of an improperly designed or constructed larger assembly or building may result in serious damage to Sto products, and to the structure of the building or its components.

STO CORP. DISCLAIMS ALL WARRANTIES EXPRESSED OR IMPLIED EXCEPT FOR EXPLICIT LIMITED WRITTEN WARRANTIES ISSUED TO AND ACCEPTED BY BUILDING OWNERS IN ACCORDANCE WITH STO'S WARRANTY PROGRAMS WHICH ARE SUBJECT TO CHANGE FROM TIME TO TIME. For the fullest, most current information on proper application, clean-up, mixing and other specifications and warranties, cautions and disclaimers, please refer to the Sto Corp. website, www.stocorp.com.

Property of Sto Corp. All Rights Reserved.

www.stocorp.com



StoQuik® Finish System for Insulated Concrete Forms (ICF) Interior Foundation Protection

Detail No.: 17.10
Date: November 2022

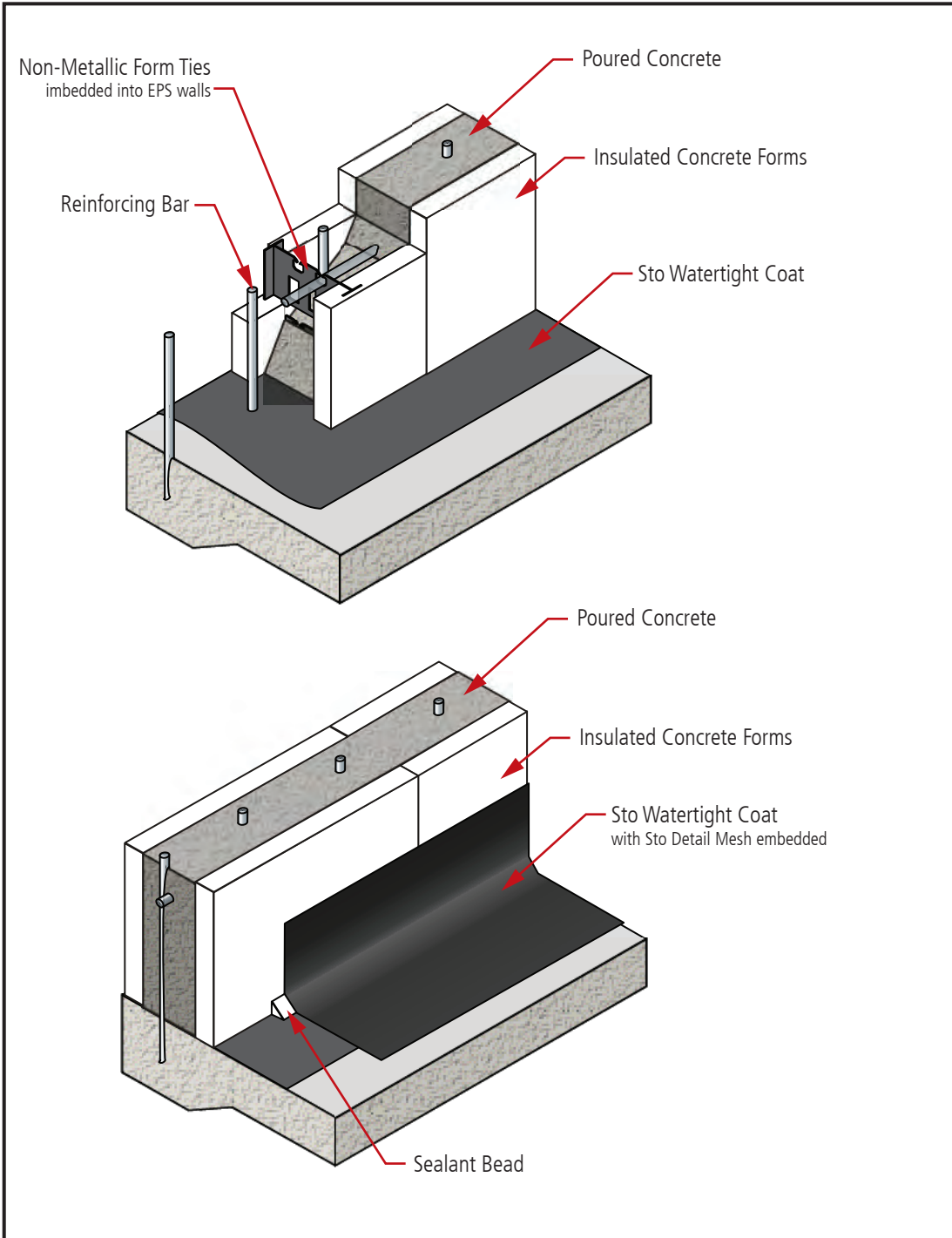

Notes:

1. Refer to System Specifications and System Bulletin for more information and design guidance on wall assembly components.
2. Allow the concrete slab to cure for 7 (minimum) to 28 days. Install an application of Sto Watertight Coat* to the prepared concrete around the perimeter of the foundation sealing around the reinforcing bars set in the foundation.
3. Install the ICF wall, pouring the concrete onto the Sto Watertight Coat. Sto Flexyl is an acceptable substitute for Sto Watertight Coat.
4. Allow the concrete in the ICF to cure for a minimum 28 days.
5. Install a second application of Sto Watertight Coat and Sto Detail Mesh over the initial application and up the wall to the desired height. Use a sealant bead at the base of the wall.
6. Provide protection board and drainage around foundation perimeter.
7. Components not identified as Sto are furnished by other manufacturers and are not necessarily installed by trades who install the Sto products. Refer to project specific contract documents.

ATTENTION

Property of Sto Corp. All Rights Reserved.

www.stocorp.com

Sto products are intended for use by qualified professional contractors, not consumers, as a component of a larger construction assembly as specified by a qualified design professional, general contractor or builder. They should be installed in accordance with those specifications and Sto's instructions. Sto Corp. disclaims all, and assumes no, liability for on-site inspections, for its products applied improperly, or by unqualified persons or entities, or as part of an improperly designed or constructed building, for the nonperformance of adjacent building components or assemblies, or for other construction activities beyond Sto's control. Improper use of Sto products or use as part of an improperly designed or constructed larger assembly or building may result in serious damage to Sto products, and to the structure of the building or its components.

STO CORP. DISCLAIMS ALL WARRANTIES EXPRESSED OR IMPLIED EXCEPT FOR EXPLICIT LIMITED WRITTEN WARRANTIES ISSUED TO AND ACCEPTED BY BUILDING OWNERS IN ACCORDANCE WITH STO'S WARRANTY PROGRAMS WHICH ARE SUBJECT TO CHANGE FROM TIME TO TIME.
For the fullest, most current information on proper application, clean-up, mixing and other specifications and warranties, cautions and disclaimers, please refer to the Sto Corp. website, www.stocorp.com.



StoQuik® Finish System for Insulated Concrete Forms (ICF) Below Grade Components

Detail No.: 17.11

Date: November 2022

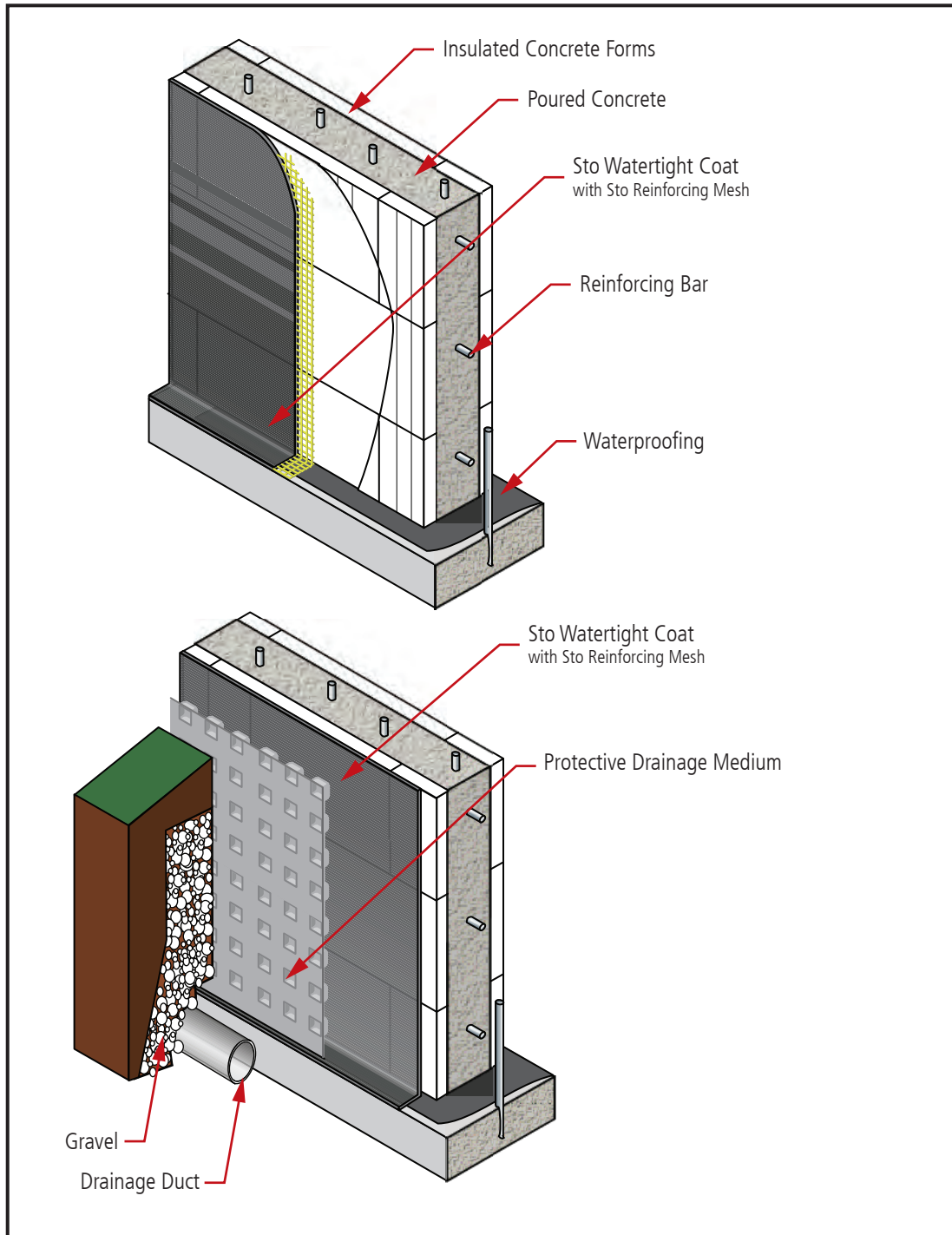

Notes:

1. Refer to System Specifications and System Bulletin for more information and design guidance on wall assembly components.
2. Concrete shall be allowed to cure for a minimum of 28 days prior to application of Sto coating materials.
3. Rasp ICF so that the surface is smooth and free of form markings.
4. Apply Sto Watertight Coat to the ICF and onto the footing. Immediately embed Sto Reinforcing Mesh.
5. Install a protective drainage medium over the waterproofed form to allow for free drainage and to protect the ICF from back-filling damage.
6. Consult ICF manufacturer and the local code authority having jurisdiction for requirements related to control of termites and other insects.
7. Components not identified as Sto are furnished by other manufacturers and are not necessarily installed by trades who install the Sto products. Refer to project specific contract documents.

ATTENTION

Property of Sto Corp. All Rights Reserved.

www.stocorp.com

Sto products are intended for use by qualified professional contractors, not consumers, as a component of a larger construction assembly as specified by a qualified design professional, general contractor or builder. They should be installed in accordance with those specifications and Sto's instructions. Sto Corp. disclaims all, and assumes no, liability for on-site inspections, for its products applied improperly, or by unqualified persons or entities, or as part of an improperly designed or constructed building, for the nonperformance of adjacent building components or assemblies, or for other construction activities beyond Sto's control. Improper use of Sto products or use as part of an improperly designed or constructed larger assembly or building may result in serious damage to Sto products, and to the structure of the building or its components.

STO CORP. DISCLAIMS ALL WARRANTIES EXPRESSED OR IMPLIED EXCEPT FOR EXPLICIT LIMITED WRITTEN WARRANTIES ISSUED TO AND ACCEPTED BY BUILDING OWNERS IN ACCORDANCE WITH STO'S WARRANTY PROGRAMS WHICH ARE SUBJECT TO CHANGE FROM TIME TO TIME. For the fullest, most current information on proper application, clean-up, mixing and other specifications and warranties, cautions and disclaimers, please refer to the Sto Corp. website, www.stocorp.com.



StoQuik® Finish System for Insulated Concrete Forms (ICF) Residential Window Sill

Detail No.: 17.23

Date: November 2022

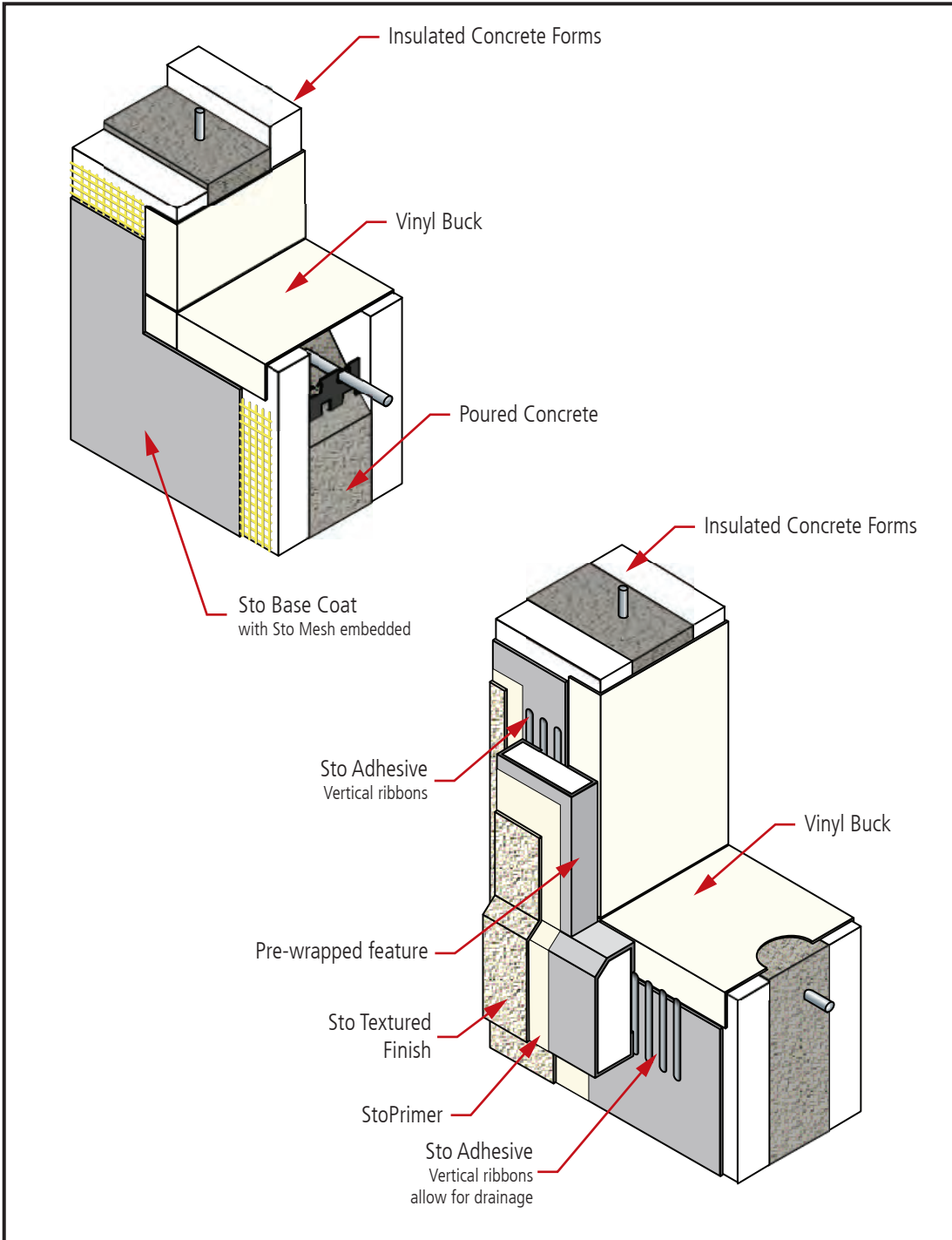

Notes:

1. Refer to System Specifications and System Bulletin for more information and design guidance on wall assembly components.
2. Detail does not illustrate the installation of the window, flashing or other opening protection required by code.
3. Install Sto Base Coat and Mesh over the ICF up to the vinyl buck flange.
4. If the selected window has a nailing flange, install the window and appropriate flashing ahead of the feature trim around the window.
5. Install the pre-wrapped feature around the window using vertical ribbons of adhesive. Allow drainage below the sill feature.
6. Non-flanged windows and flashing may be installed after the feature trim is installed.
7. Limit dimension of vinyl buck to no more than 20% of feature width.
8. Components not identified as Sto are furnished by other manufacturers and are not necessarily installed by trades who install the Sto products. Refer to project specific contract documents.

ATTENTION

Property of Sto Corp. All Rights Reserved.

www.stocorp.com

Sto products are intended for use by qualified professional contractors, not consumers, as a component of a larger construction assembly as specified by a qualified design professional, general contractor or builder. They should be installed in accordance with those specifications and Sto's instructions. Sto Corp. disclaims all, and assumes no, liability for on-site inspections, for its products applied improperly, or by unqualified persons or entities, or as part of an improperly designed or constructed building, for the nonperformance of adjacent building components or assemblies, or for other construction activities beyond Sto's control. Improper use of Sto products or use as part of an improperly designed or constructed larger assembly or building may result in serious damage to Sto products, and to the structure of the building or its components.

STO CORP. DISCLAIMS ALL WARRANTIES EXPRESSED OR IMPLIED EXCEPT FOR EXPLICIT LIMITED WRITTEN WARRANTIES ISSUED TO AND ACCEPTED BY BUILDING OWNERS IN ACCORDANCE WITH STO'S WARRANTY PROGRAMS WHICH ARE SUBJECT TO CHANGE FROM TIME TO TIME. For the fullest, most current information on proper application, clean-up, mixing and other specifications and warranties, cautions and disclaimers, please refer to the Sto Corp. website, www.stocorp.com.



StoQuik® Finish System for Insulated Concrete Forms (ICF) Finished Opening - Sill

Detail No.: 17.25
Date: November 2022

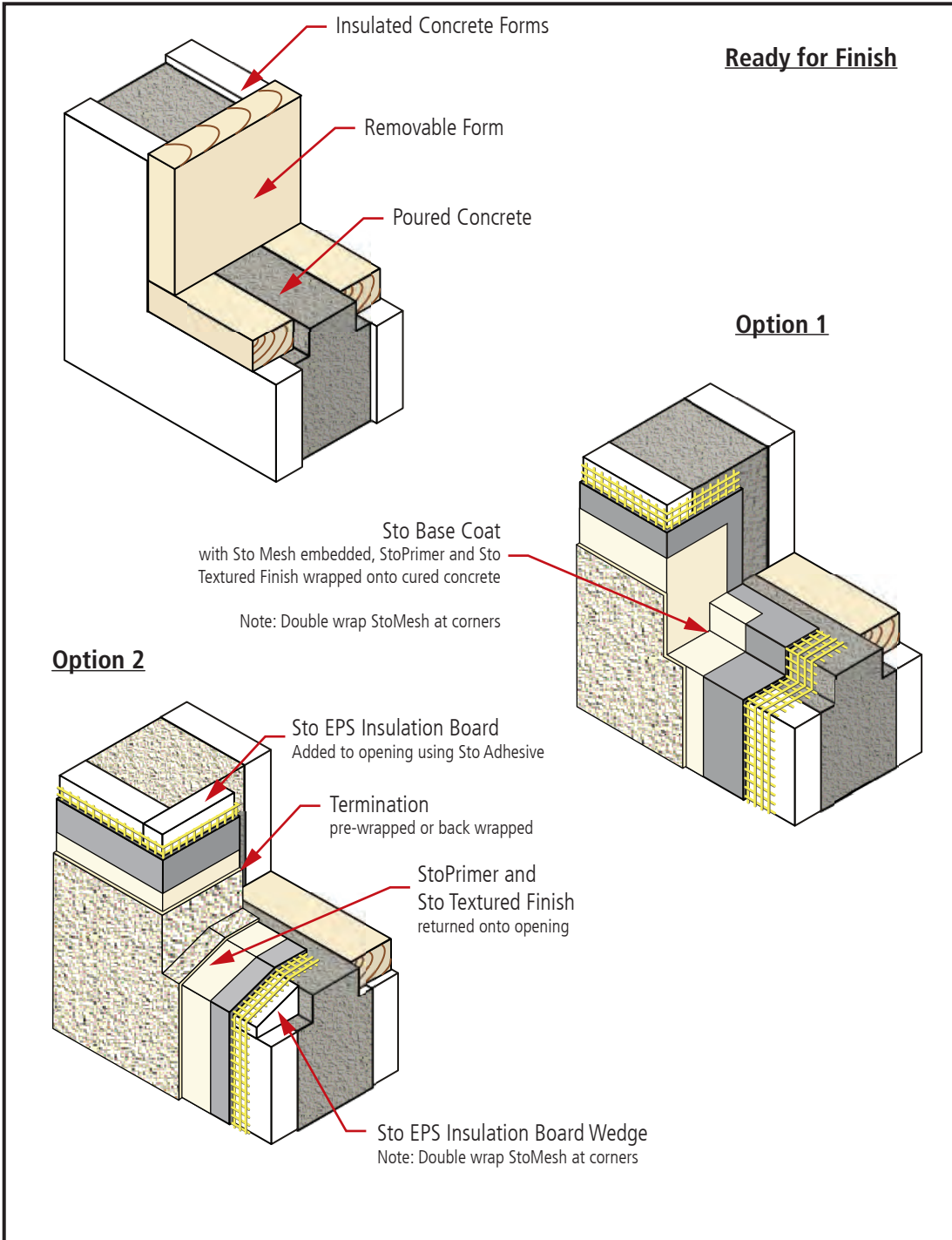

Notes:

1. Refer to System Specifications and System Bulletin for more information and design guidance on wall assembly components.

2. Detail does not illustrate the installation of the window, flashing or other opening protection required by code.

Option 1

3. Install Sto Base Coat and Sto Mesh lapping onto concrete a minimum 4" (100 mm).

4. Apply StoPrimer and Sto Textured Finish as specified.

Option 2

5. Install Sto EPS insulation board into the opening using Sto Adhesive. Prewrap the insulation with Sto Base Coat and Sto Mesh or back-wrap. Apply StoPrimer and Sto Textured Finish as specified.

6. Components not identified as Sto are furnished by other manufacturers and are not necessarily installed by trades who install the Sto products. Refer to project specific contract documents.

ATTENTION

Property of Sto Corp. All Rights Reserved.

www.stocorp.com

Sto products are intended for use by qualified professional contractors, not consumers, as a component of a larger construction assembly as specified by a qualified design professional, general contractor or builder. They should be installed in accordance with those specifications and Sto's instructions. Sto Corp. disclaims all, and assumes no, liability for on-site inspections, for its products applied improperly, or by unqualified persons or entities, or as part of an improperly designed or constructed building, for the nonperformance of adjacent building components or assemblies, or for other construction activities beyond Sto's control. Improper use of Sto products or use as part of an improperly designed or constructed larger assembly or building may result in serious damage to Sto products, and to the structure of the building or its components.

STO CORP. DISCLAIMS ALL WARRANTIES EXPRESSED OR IMPLIED EXCEPT FOR EXPLICIT LIMITED WRITTEN WARRANTIES ISSUED TO AND ACCEPTED BY BUILDING OWNERS IN ACCORDANCE WITH STO'S WARRANTY PROGRAMS WHICH ARE SUBJECT TO CHANGE FROM TIME TO TIME. For the fullest, most current information on proper application, clean-up, mixing and other specifications and warranties, cautions and disclaimers, please refer to the Sto Corp. website, www.stocorp.com.

